



COMPIT/E + COMPIT/E⁺

INSTRUCTIONS FOR USE
LAST UPDATED 03.2019



CONTENTS

Information concerning the Instructions and the Manufacturer	4
Keep the instructions at hand	4
Design characteristics of these instructions	4
Copyright	5
Address of the Manufacturer	5
Safety	6
Intended use	6
Basic Safety Instructions	7
Avoid fire, explosions or electric shocks	7
Avoid a cardiac pacemaker or other implant failure	7
Design characteristics of the warning instructions	8
Design characteristics of tips	8
Description	9
Overview of the COMPIT/E's scope of delivery	9
Overview of the COMPIT/E+'s scope of delivery	11
Overview of the COMPIT/E without the COM/LIGHT	13
Overview of the COMPIT/E+ with COM/LIGHT	14
COM/LIGHT overview	15
+COM/UNIT overview	16
LED status indicator	17
Task and Function	18
COMPIT/E	18
COMPIT/E+	18
Technical Data	19
Unpacking and Checking the Scope of Delivery	20
Mounting the COMPIT/E and COMPIT/E+ on and removing them from the bicycle's handlebar	21
Requirement	21
Disassembling the on-board computer from the bicycle	22
Without COM/LIGHT	23
With COM/LIGHT	26
Mounting your smartphone on the COMPIT/E or COMPIT/E+ and removing it	33
Adjusting the Inclination	35
Charging the Smartphone via the +COM/UNIT	36
Cableless charging of the smartphone	36
Charging the smartphone with a cable	38
Using the NFC	39
Charging the +COM/UNIT and your smartphone using your e-bike's on-board computer	40
Charging the +COM/UNIT	42
Troubleshooting	43
Caring for the Product	44
Accessories	45
Disposing of the Product	46
In Germany	46
Outside Germany	46
Warranty Declaration	47
Returns to Customer Service	48

Information concerning the Instructions and the Manufacturer

These instructions help you to use the "COMPIT" and "COMPIT+" product range safely.

The COMPIT is a smartphone holder for smartphones.

The COMPIT+ comprises the COMPIT and the +COM/UNIT.

The +COM/UNIT is a charging and communication station for smartphones.

The COMPIT and the +COM/UNIT are hereafter referred to as the "product" as long as it is not necessary to differentiate between different product functions.

Keep the instructions at hand

- These instructions are a constituent part of the product.
- Always keep these instructions.
- Please pass these instructions on if you sell the product or pass it on in another form.

Design characteristics of these instructions

Various elements in these instructions include clearly determined characteristics. You can easily differentiate between the following elements:

Normal text

- Enumerations
- Action steps

DESIGNATION OF PRODUCTS

Copyright

These instructions include information that is protected by copyright. These instructions are not to be copied, printed out, filmed, processed, duplicated or distributed in any form whatsoever, whether in part or in its entirety without prior written approval of SKS metaplast Scheffer-Klute GmbH.

©2019 SKS metaplast Scheffer-Klute GmbH

All rights reserved.

Address of the Manufacturer

SKS metaplast Scheffer-Klute GmbH

Zur Huberstushalle 4

59846 Sundern, Germany

Tel.: +49-2933-8310

Website: www.sks-germany.com

Safety

Intended use

The product is designed for private use.

The COMPIT/E and COMPIT/E+ are used to mount a smartphone on an e-bike's handlebar. They are only compatible with the Bosch Intuvia/Nyon on-board computer. They are intended for handlebars with the following diameters.

- 22,2 mm
- 25,4 mm
- 31,8 mm.

The +COM/UNIT is included in the COMPIT/E+'s scope of delivery.

The +COM/UNIT is intended for charging your smartphone with or without a Qi charging function and can be mounted on the COMPIT/E.

The smartphone can only be used on the COMPIT/E and the +COM/UNIT with a cover (not included in the scope of delivery). Please refer to the section entitled Accessories, page 45.

Intended use also includes observing and following all the information contained in these instructions, particularly the safety instructions. Any other use is expressly considered improper.

Basic Safety Instructions

Avoid fire, explosions or electric shocks

Severe or fatal injuries caused by explosion, fire or electric shock may be caused if the product is used improperly.

- Check whether the voltage indicated on the power adapter is the same as the local mains voltage before connecting the adapter to the power supply.
- Only use authorised power adapters.
- Do not use the power adapter, the COMPIT/E, the COMPIT/E+ or the +COM/UNIT if they are damaged.
- Never open the +COM/UNIT's housing. Always have repair work carried out by qualified specialists.
- Do not stick metal labels or other objects on the +COM/UNIT.
- Do not use the +COM/UNIT in the vicinity of heated surfaces.
- Do not use extension cables or overloaded power strips.
- Ensure that children and persons with reduced mental capabilities only use the +COM/UNIT when supervised.

Avoid a cardiac pacemaker or other implant failure

A cardiac pacemaker or other implant failure can occur when using the +COM/UNIT.

- Should you have a cardiac pacemaker or another implant, please consult your doctor or the implant manufacturer before using the +COM/UNIT.

Design characteristics of the warning instructions

 CAUTION	
	Instructions with the word CAUTION warn of a situation that could result in slight or moderate injuries.

Design characteristics of tips

 Tips provide additional information.

Overview of the COMPIT/E's scope of delivery

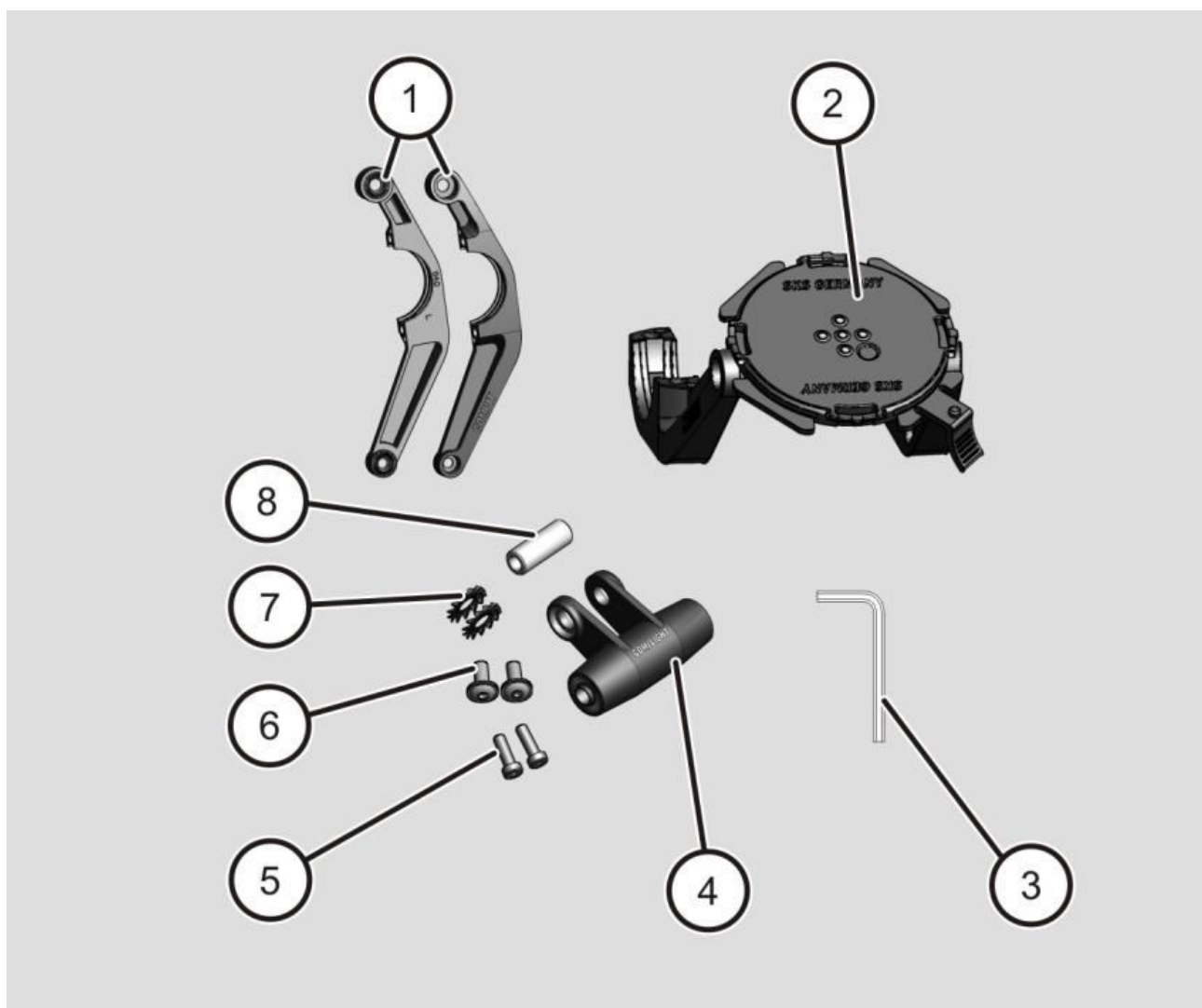

Nr.	Designation
1	Clamping arms for COMPIT/E with adapter (R: right, L: left), 2x
2	Docking station for mounting the smartphone with cover or the +COM/UNIT
3	3 mm Allen key
4	COM/LIGHT adapter
5	Screws for mounting the COM/LIGHT adapter (M5 x 16)
6	Screws for mounting the front light (M4 x 8), 2x

Description

Nr.	Designation
7	Locking washers for mounting the front light, 2x
8	Shaft for affixing the front light

① The cover and the front light are not included in the scope of delivery.

Overview of the COMPIT/E+'s scope of delivery

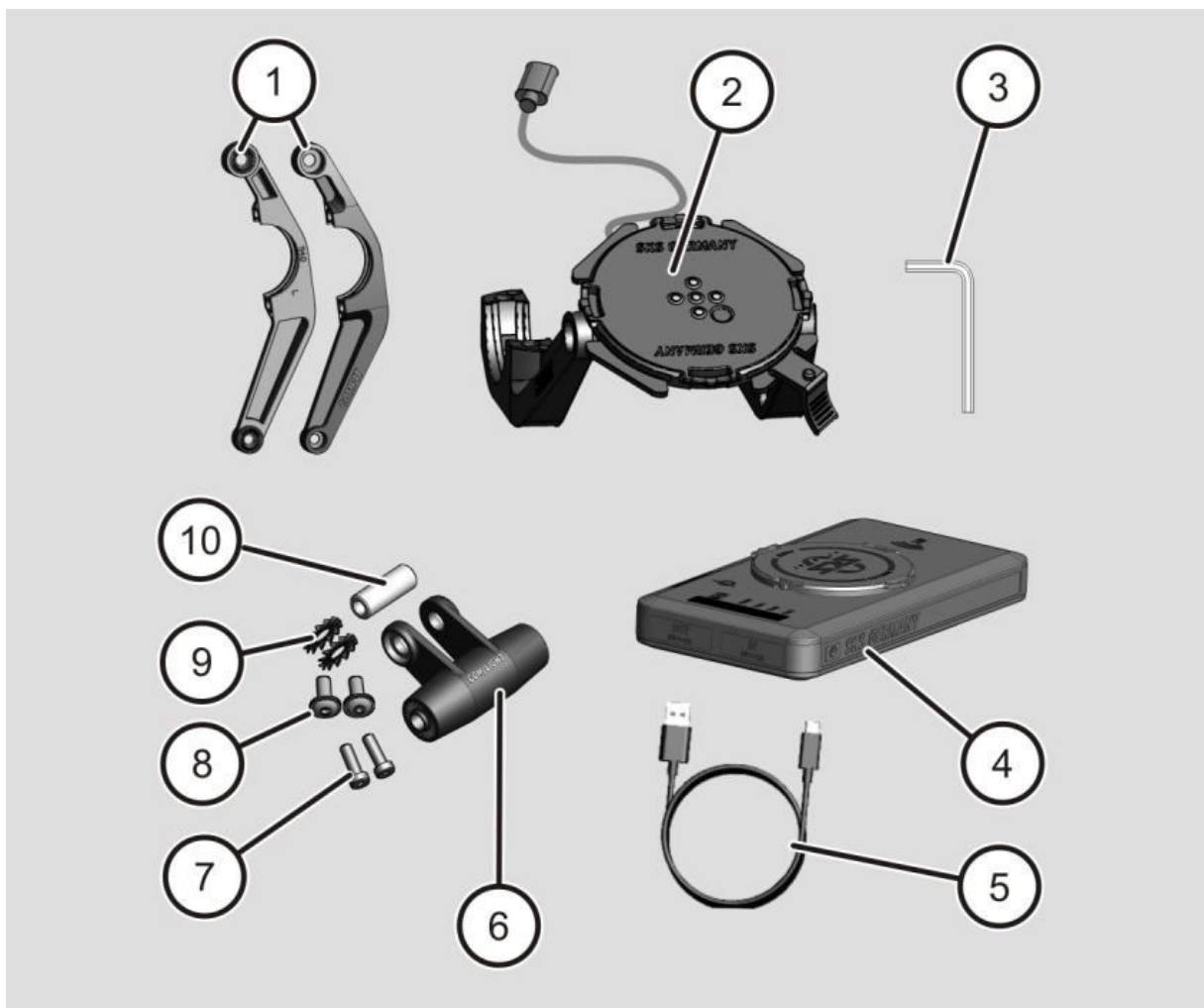

Nr.	Designation
1	Clamping arms for COMPIT/E+ with adapter (R: right, L: left), 2x
2	Docking station for mounting the smartphone with cover or the +COM/UNIT
3	3 mm Allen key
4	+COM/UNIT
5	USB cable for charging the +COM/UNIT
6	COM/LIGHT adapter
7	Screws for mounting the COM/LIGHT adapter (M5 x 16), 2x
8	Screws for mounting the front light (M4 x 8), 2x

Description

Nr.	Designation
9	Locking washers for mounting the front light, 2x
10	Shaft for affixing the front light

① The cover and the front light are not included in the scope of delivery.

Overview of the COMPIT/E without the COM/LIGHT

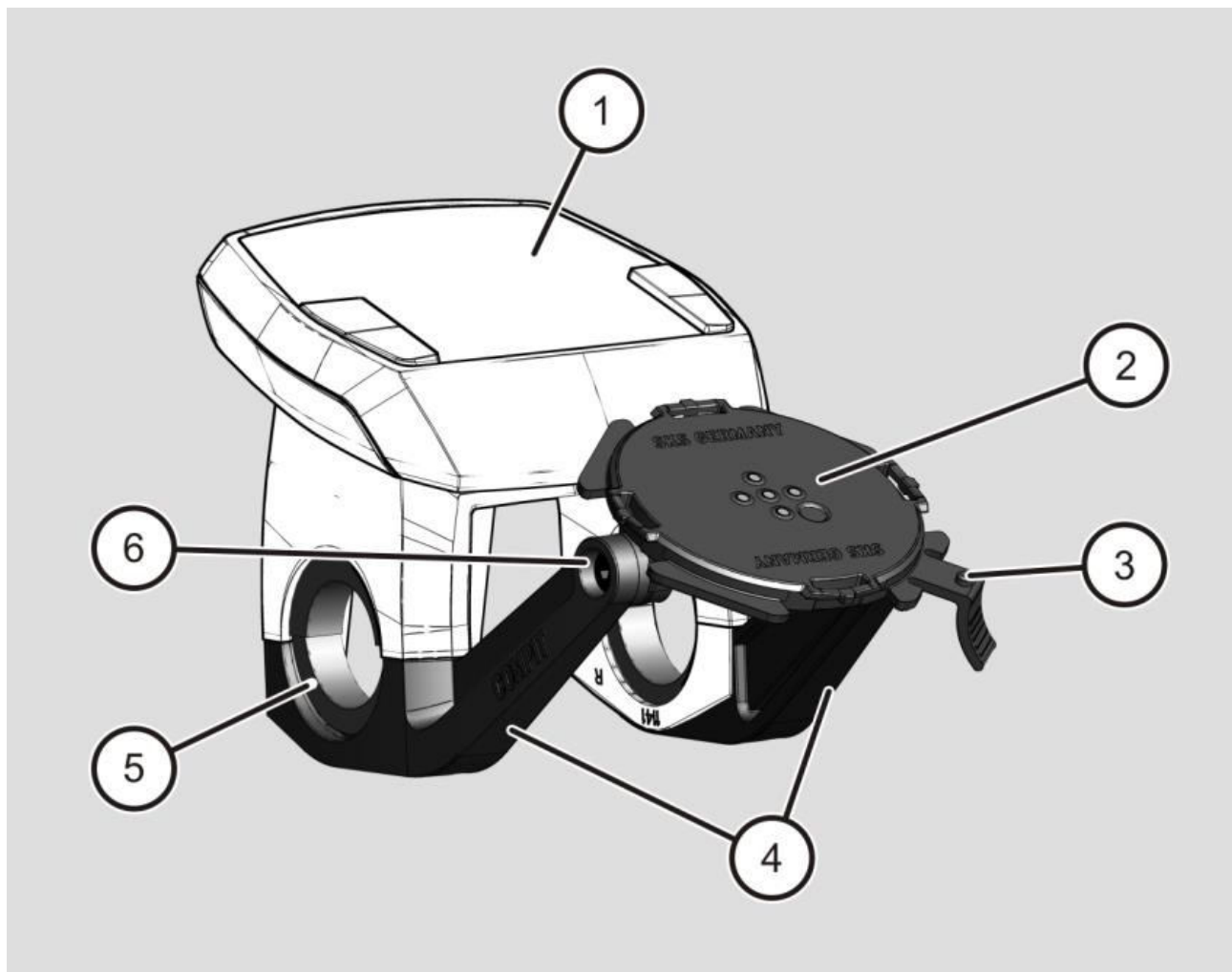

Nr.	Designation
1	Blntuvia on-board computer (not included in the scope of delivery)
2	Docking station for mounting the smartphone with cover or the +COM/UNIT
3	Safety lever for locking the smartphone with cover or the +COM/UNIT
4	Clamping arms
5	Rubber adapter (on both sides)
6	Levelling screw (on both sides)

Overview of the COMPIT/E+ with COM/LIGHT

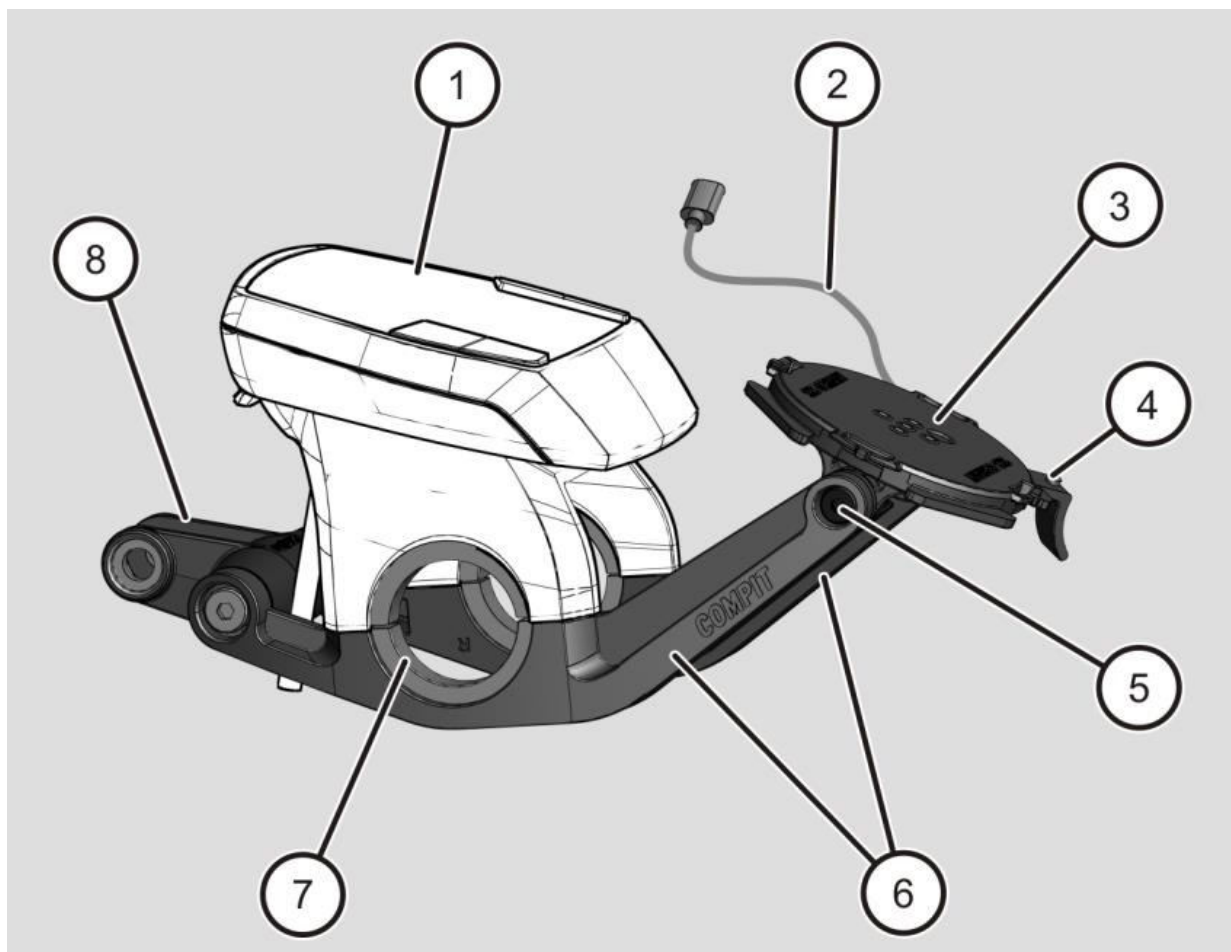

Nr.	Designation
1	Bosch Intuvia on-board computer (not included in the scope of delivery)
2	USB cable for the power supplied by the e-bike battery
3	Docking station for mounting the smartphone with cover or the +COM/UNIT with cover
4	Safety lever for locking the smartphone with cover or the +COM/UNIT
5	Levelling screw (on both sides)
6	Clamping arms
7	Rubber adapter (on both sides)
8	COM/LIGHT

COM/LIGHT overview

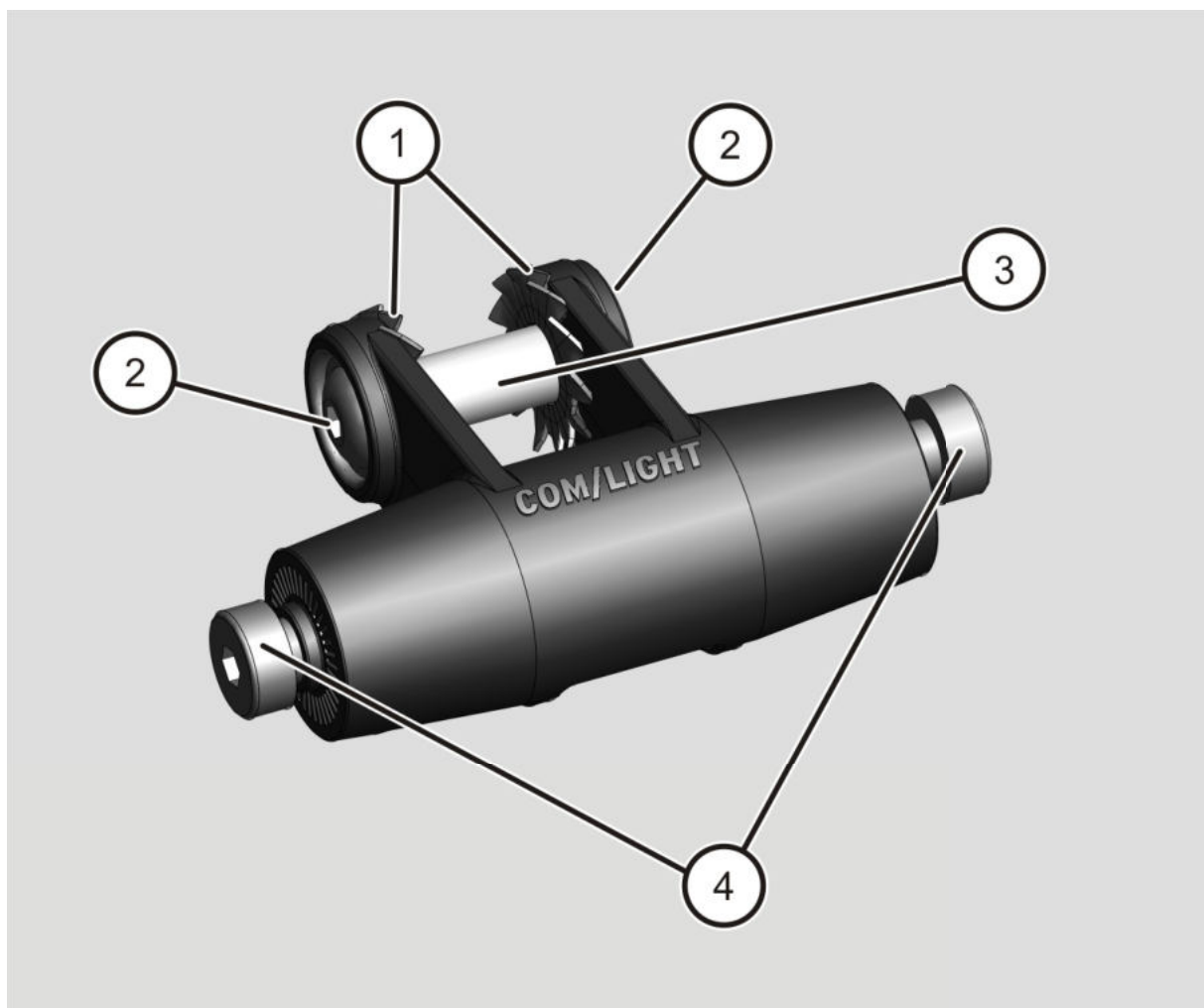

Nr.	Designation
1	Locking washer for mounting the front light
2	Screws for mounting the front light (M4x8)
3	Shaft for mounting the front light
4	Screws for mounting the COM/LIGHT adapter (M5x16)

+COM/UNIT overview

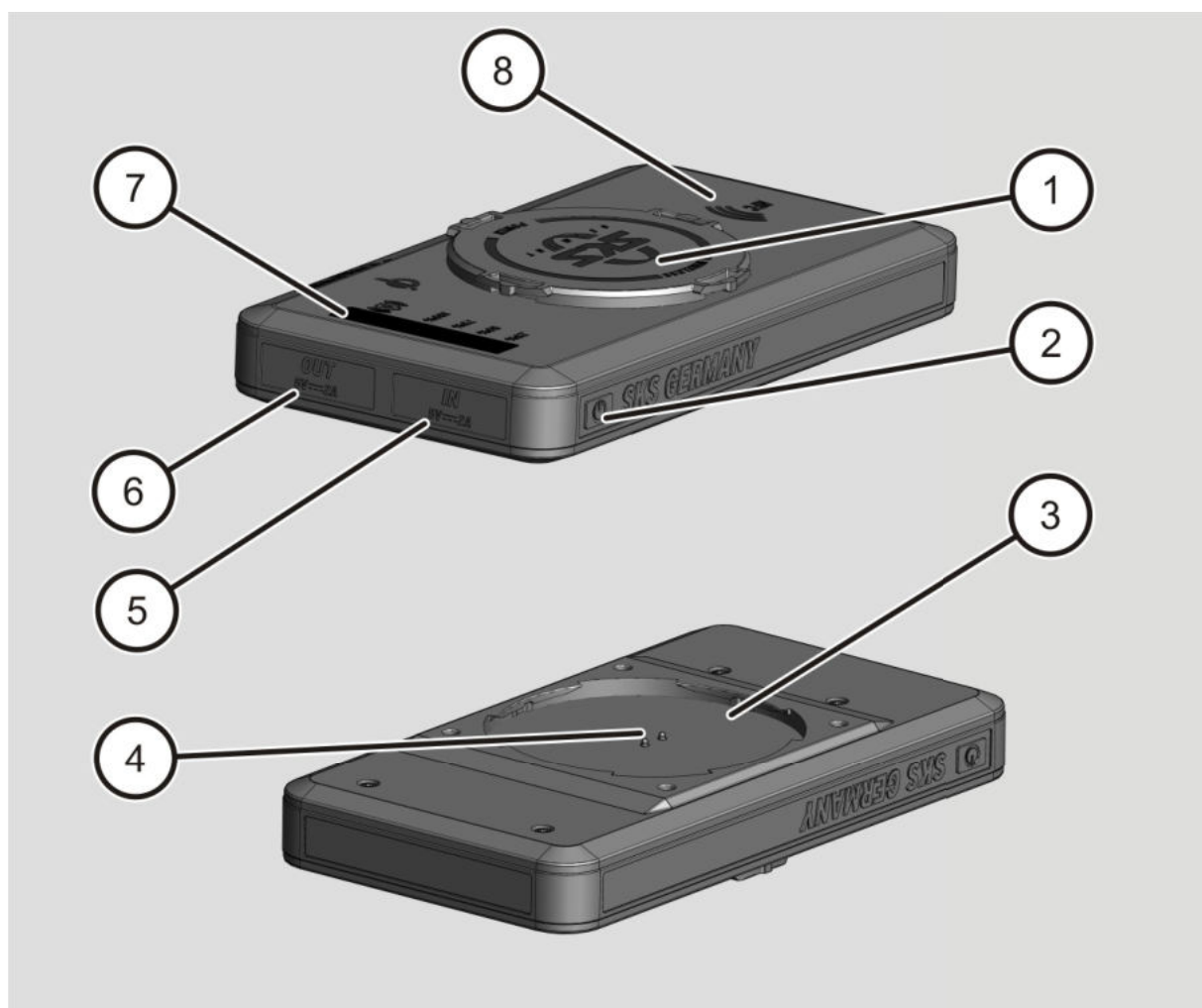

Nr.	Designation
1	Qi docking station (cableless charging) for mounting the smartphone with cover
2	Button for switching on and off
3	Docking station for mounting on the COMPIT
4	Housing input (two contact pins in the housing)
5	USB input
6	USB output
7	LED status indicator
8	NFC reading area

LED status indicator

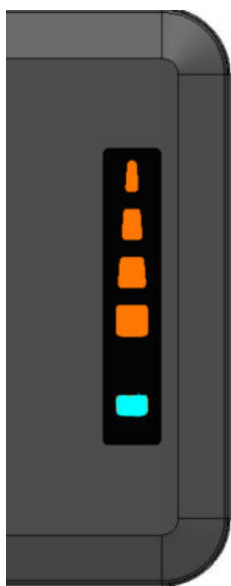
+COM/UNIT	LED	STATUS	INDICATES
	Battery indicator	4 orange LEDs flash in succession	+COM/UNIT is being charged
		1 LED illuminated	0 %-25 % battery capacity
		2 LEDs illuminated	25 %-50 % battery capacity
		3 LEDs illuminated	50 %-75 % battery capacity
		4 LEDs illuminated	75 %-100 % battery capacity
	Indicator for cableless charging	Blue	Blue Standby or charging completed
		Blue flashing approx. 1 x per second	Charging in process
		Blue flashes fast approx. 5x per second	Charging error

Task and Function

COMPIT/E

The COMPIT/E is used to mount the smartphone on the handlebar of a bicycle equipped with a Bosch Intuvia/Nyon display. On the COMPIT/E, the smartphone can be mounted horizontally and vertically by turning it with an optional cover above the docking station. The smartphone on the COMPIT/E can be brought into the desired position by adjusting the tilt.

The COM/LIGHT adapter can be affixed to the COMPIT/E to mount the front light (not included in the scope of delivery). Additionally, the COM/CAM adapter for mounting a camera (not included in the scope of delivery) can be affixed to the COMPIT/E.

COMPIT/E+

The +COM/UNIT is included in the COMPIT/E + 's scope of delivery.

The +COM/UNIT is used to charge and connect the smartphone while cycling. It can be affixed to the COMPIT/E. Smartphones that have a wireless charging function are charged by affixing the smartphone to the Qi docking station. Smartphones that do not have a Qi charging function can be charged using an optional USB cable. It is affixed using a cover (not included in the scope of delivery) by turning it above the docking station.

The +COM/UNIT on the COMPIT/E can be brought into the desired position by adjusting the tilt.

The +COM/UNIT has an NFC (near-field communication) chip. It can be equipped with different functions (please refer to page 39 regarding this matter).

The + COM/UNIT can be charged with the USB cable included in the scope of delivery.

Technical Data

+COM/UNIT	
Dimensions	130 x 70 x 21,5 mm
Weight	~188 g
USB input	DC 5 V/2 A
USB output	DC 5 V/2 A
Housing input	DC 5-15 V/2 A
Wireless transmission power	5 W
Wireless efficiency	>70%
Operating frequency	110 KHz-205 KHz
Wireless output	DC 5 V/1 A
Battery type	Rechargeable lithium-polymer battery
Battery capacity	5000 mAh
NFC chip	NTAG 216, 924 Byte
Type of protection	IP54
Discharging temperature	-15 ~ 60° C
Charging temperature	0 ~ 45° C

Unpacking and Checking the Scope of Delivery

- Remove the product from the packaging.
- Keep the original packaging in case you need to return the product to Customer Service.
- Check the scope of delivery to ensure it is correct and complete (refer to page 9 onwards).
- Check all parts to ensure that they are undamaged.
- If there are any deviations, please contact the manufacturer or dealer immediately.

Mounting the COMPIT/E and COMPIT/E+ on and removing them from the bicycle's handlebar

Requirement

You can affix the COMPIT/E and COMPIT/E+ on your bicycle if it meets the following requirements:

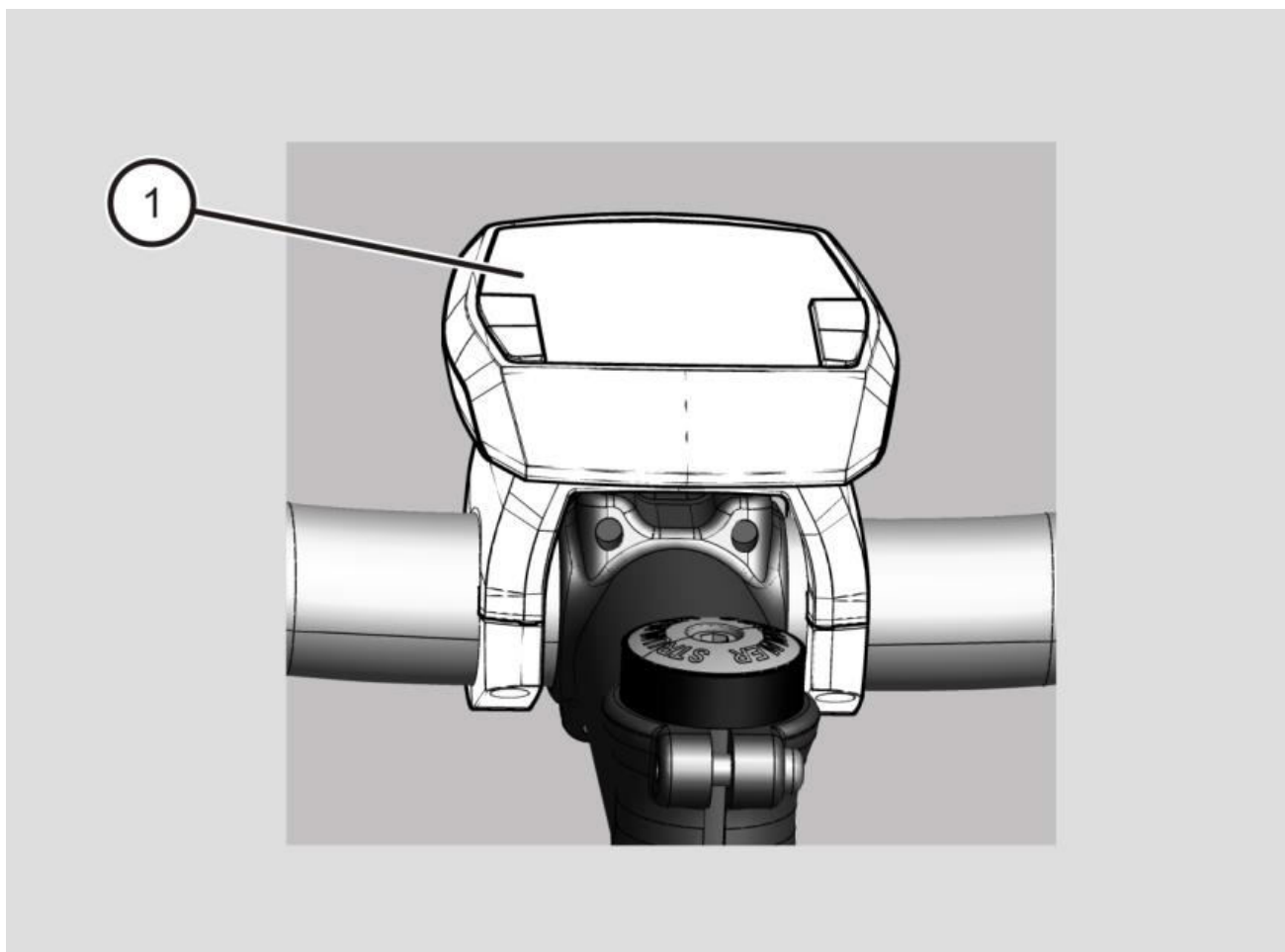

Nr.	Explanation
1	On-board computer Type: Bosch Intuvia or Bosch Nyon

Disassembling the on-board computer from the bicycle

The COMPIT/E and COMPIT/E+, including the on-board computer, are mounted on the bicycle's handlebar. To this end, you must remove the on-board computer's clamping arms and mount the clamping arms of the COMPIT/E or COMPIT/E+. Proceed as follows to disassemble the on-board computer:

- Loosen the screws (2) on the clamping arms (3) of the on-board computer (1).
- Set the four screws (2) aside for reuse.
- Remove the clamping arms (3).
- Remove the rubber adapters from the clamping arms (3) and set them aside for reuse.
- Mount the COMPIT/E or COMPIT/E+ and the on-board computer (1) on the bicycle as described on page 23 onwards.

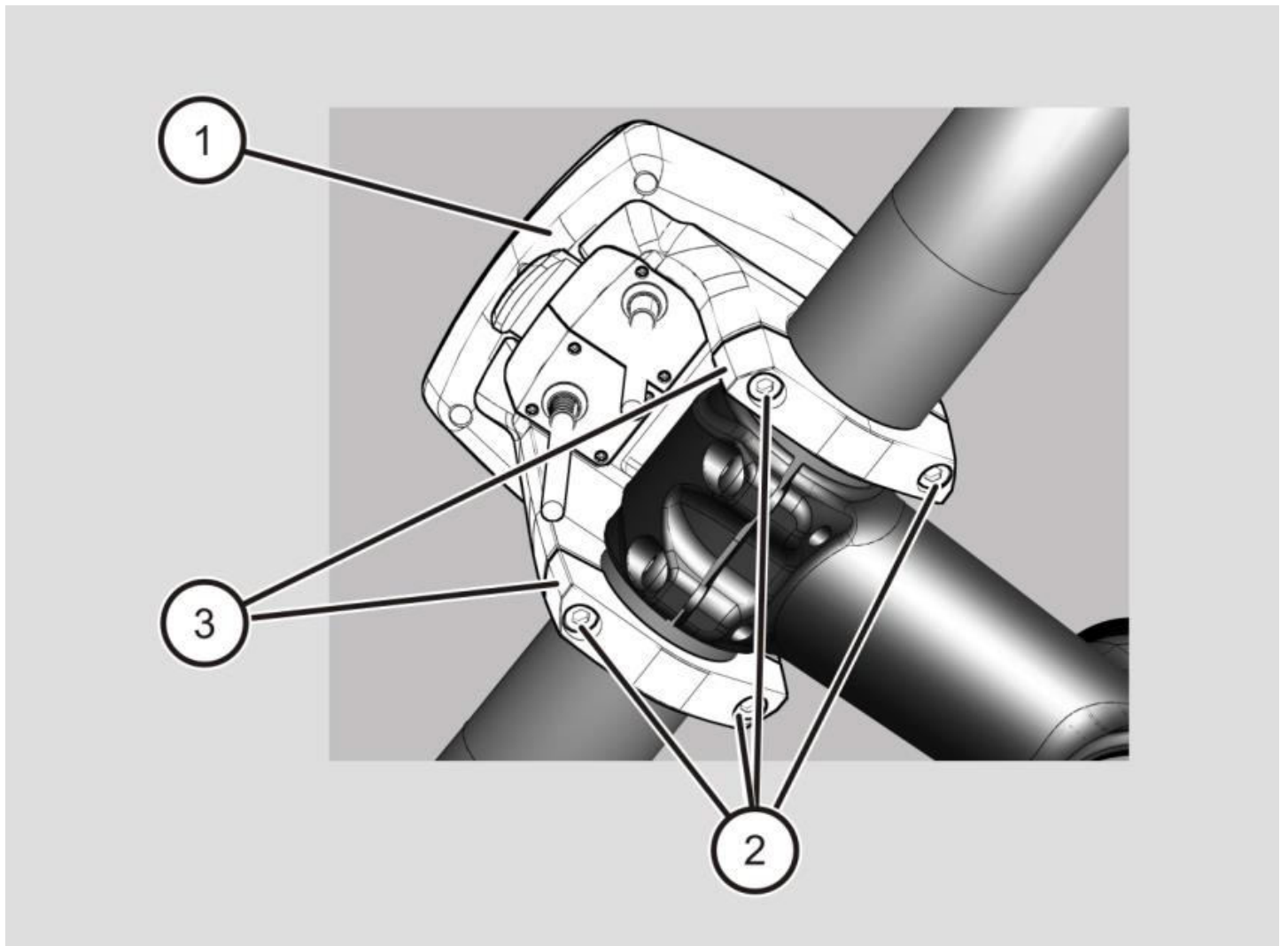

i We have provided a description below of how to mount the COMPIT/E on the vehicle and remove it, both with and without the COM/LIGHT. The COMPIT/E+ is mounted on/removed from the bicycle in the same way as the COMPIT/E.

Without COM/LIGHT

- Insert the rubber adapters (1) of the on-board computer into the clamping arms in the direction of the arrows as shown below.

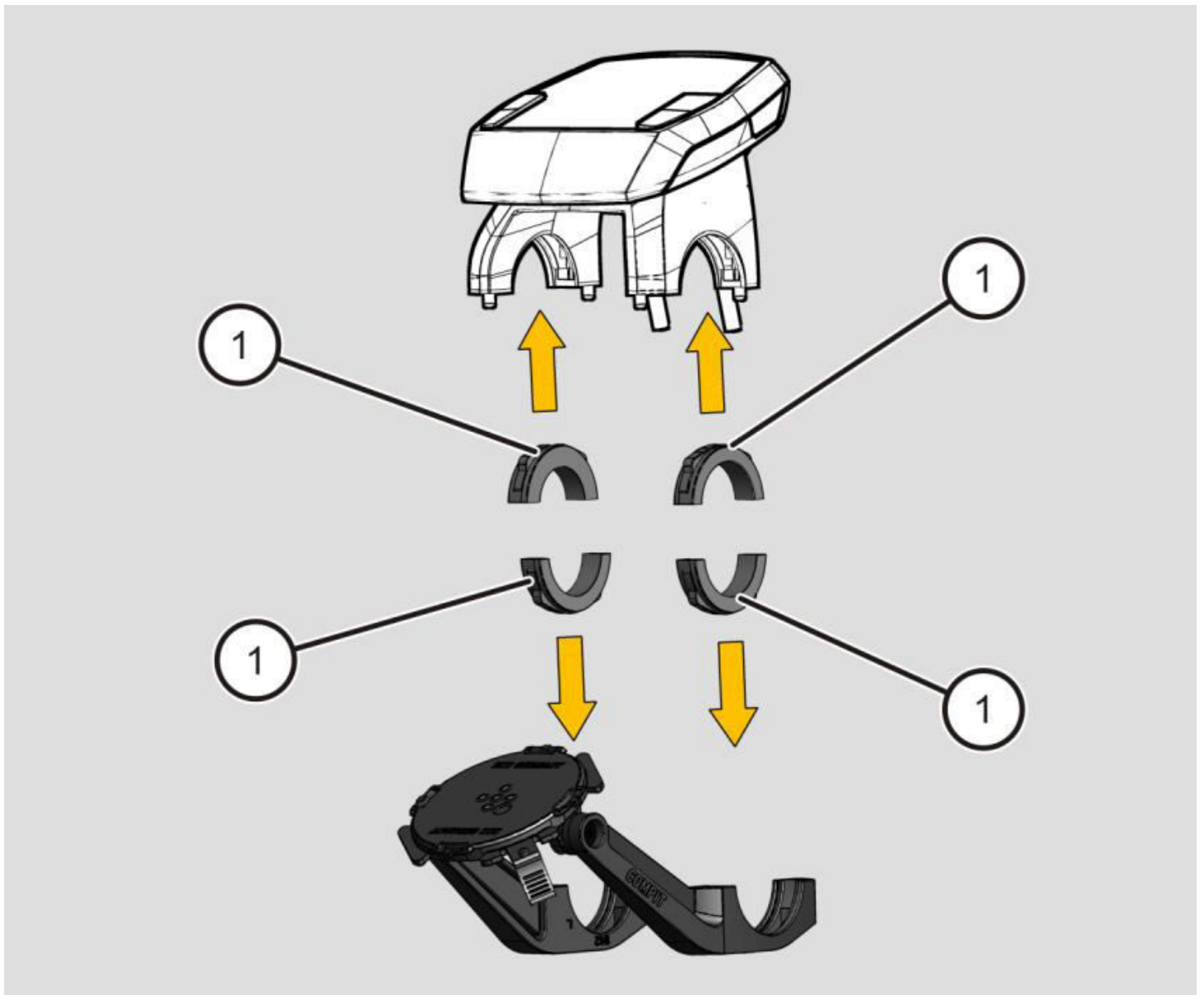

Mounting the COMPIT/E and COMPIT/E+ on and removing them from the bicycle's handlebar

- Affix the e-bike's on-board computer (2) and the COMPIT/E's clamping arms (3) on the bicycle's handlebar.

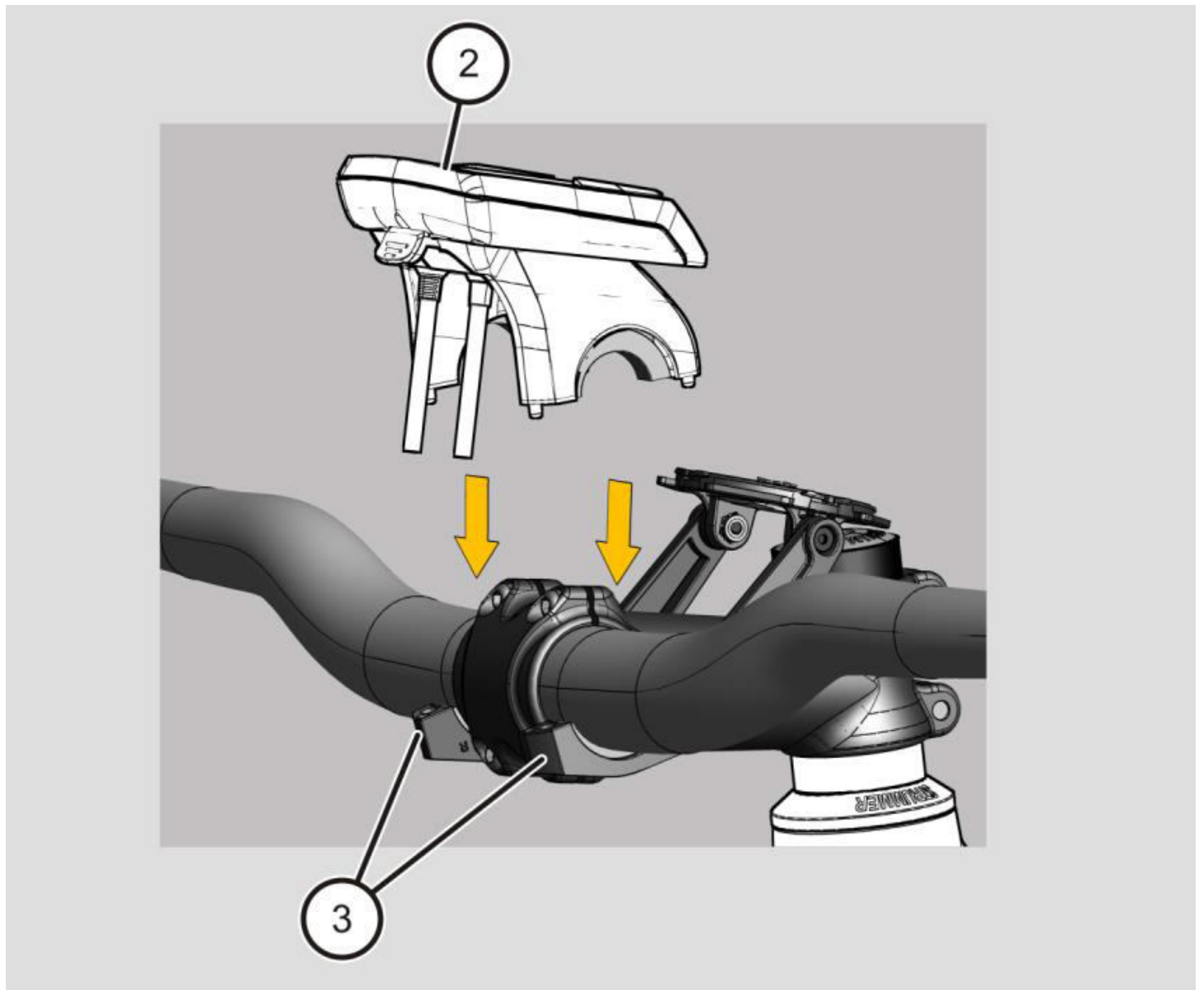

CAUTION



If the screws are not tightened evenly when mounting the COMPIT/E on the bicycle, the COMPIT/E may come loose from the bicycle and cause injury.

- When mounting the COMPIT/E, tighten the screws evenly, alternating between them.

- Mount the COMPIT/E on the handlebar with a torque wrench. To do so, tighten the screws (4) evenly (alternating between them) using the torque (1 Nm) indicated on the clamping arms.

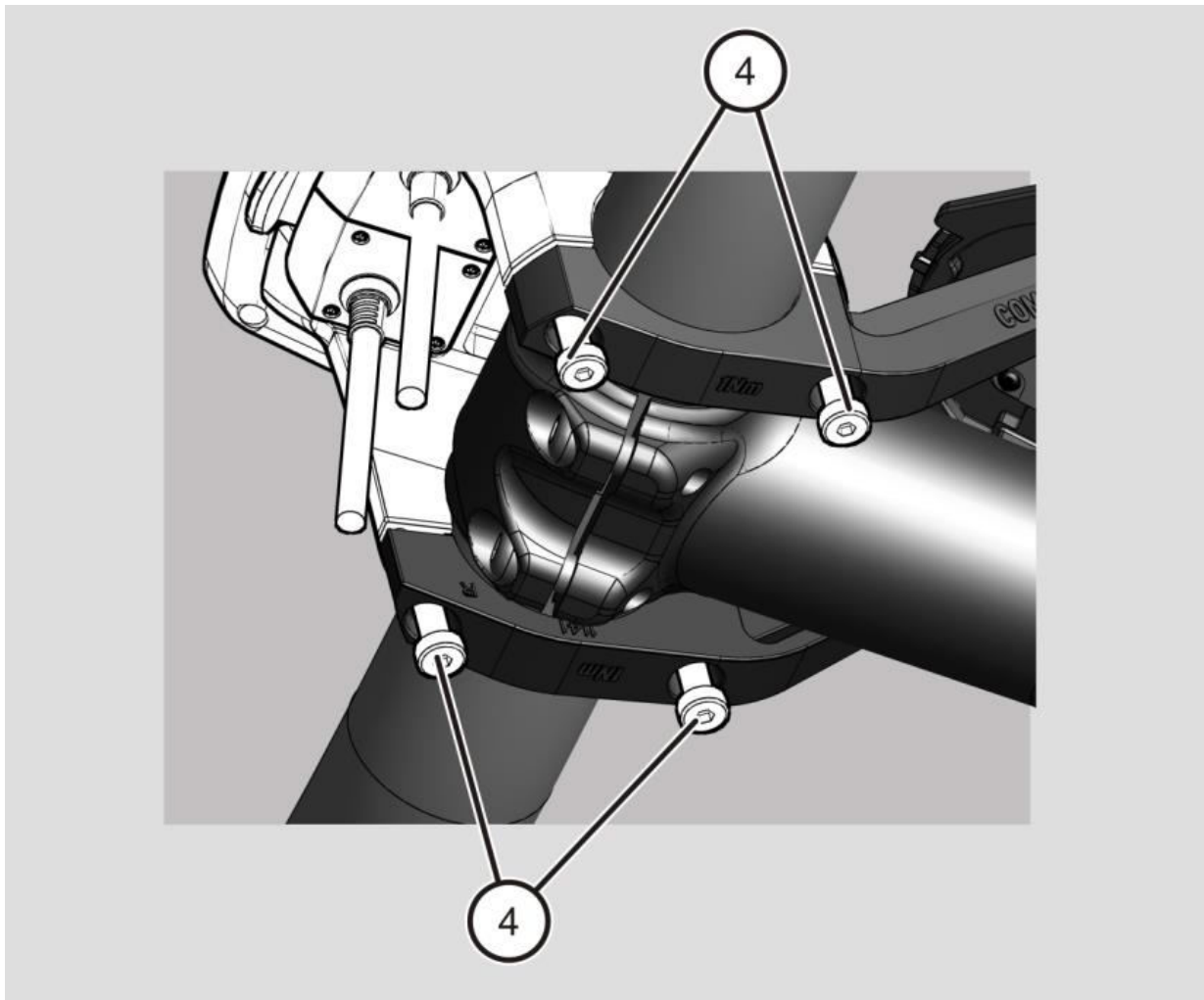

Proceed as follows to remove the COMPIT/E from the bicycle's handlebar:

- Loosen the screws.
- Remove the COMPIT/E from the bicycle's handlebar using the clamping arms.

With COM/LIGHT

To mount the COMPIT/E with COM/LIGHT on the bicycle's handlebar, you must first remove the docking station from the clamping arms without the COM/LIGHT adapter. Proceed as follows to do so:

- Loosen the levelling screws (1)
- Now remove the docking station (2).

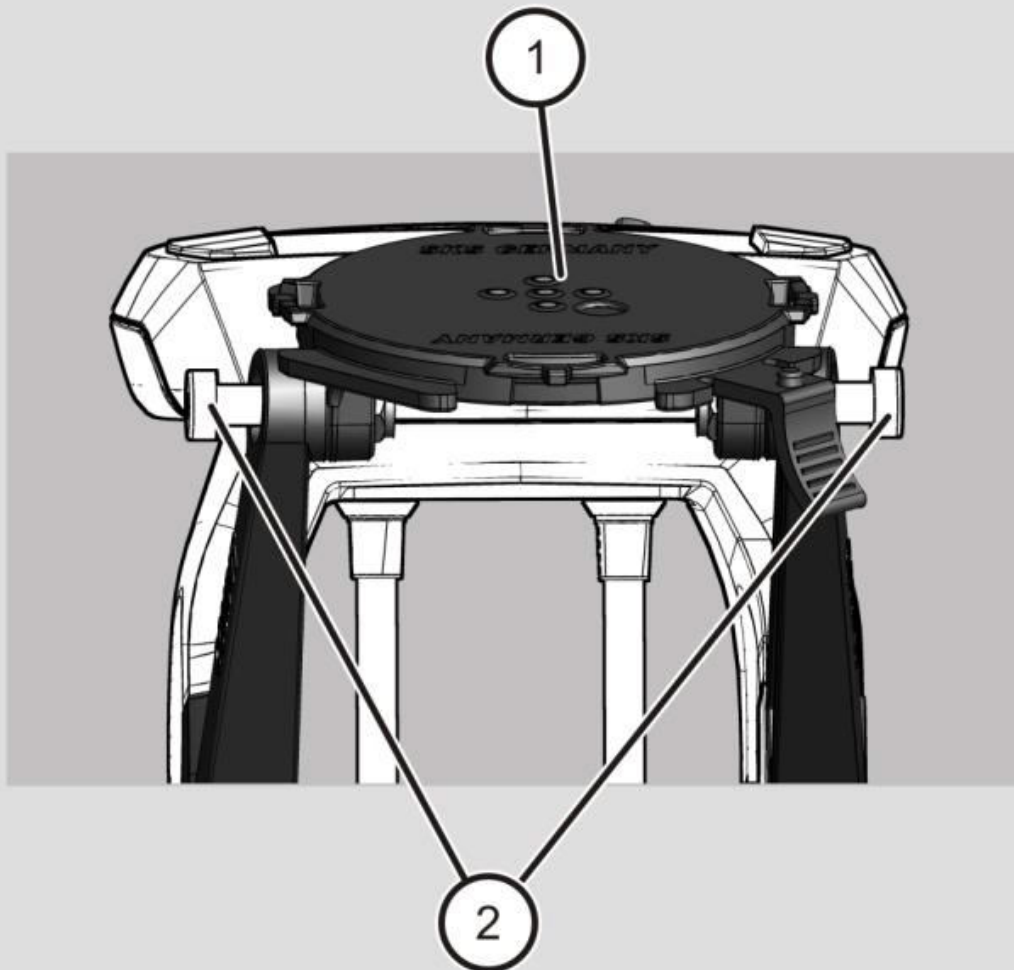

Mounting the COMPIT/E and COMPIT/E+ on and removing them from the bicycle's handlebar

- Now affix the clamping arms (5) for the COM/LIGHT adapter on the docking station (4).
- Tighten the screws (3) slightly.

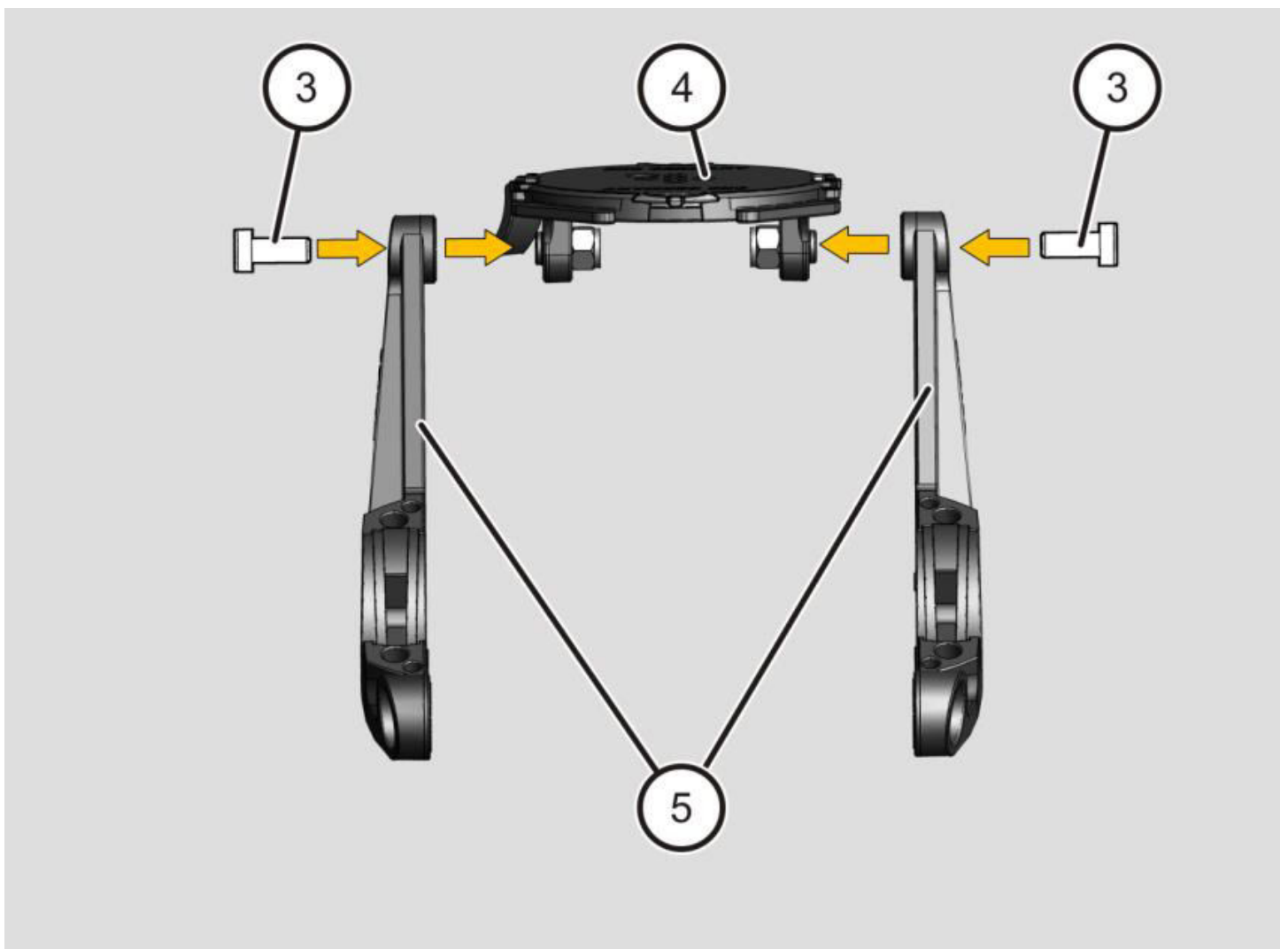

Mounting the COMPIT/E and COMPIT/E+ on and removing them from the bicycle's handlebar

- Insert the rubber adapters (6) of the on-board computer into the clamping arms in the direction of the arrows as shown below.

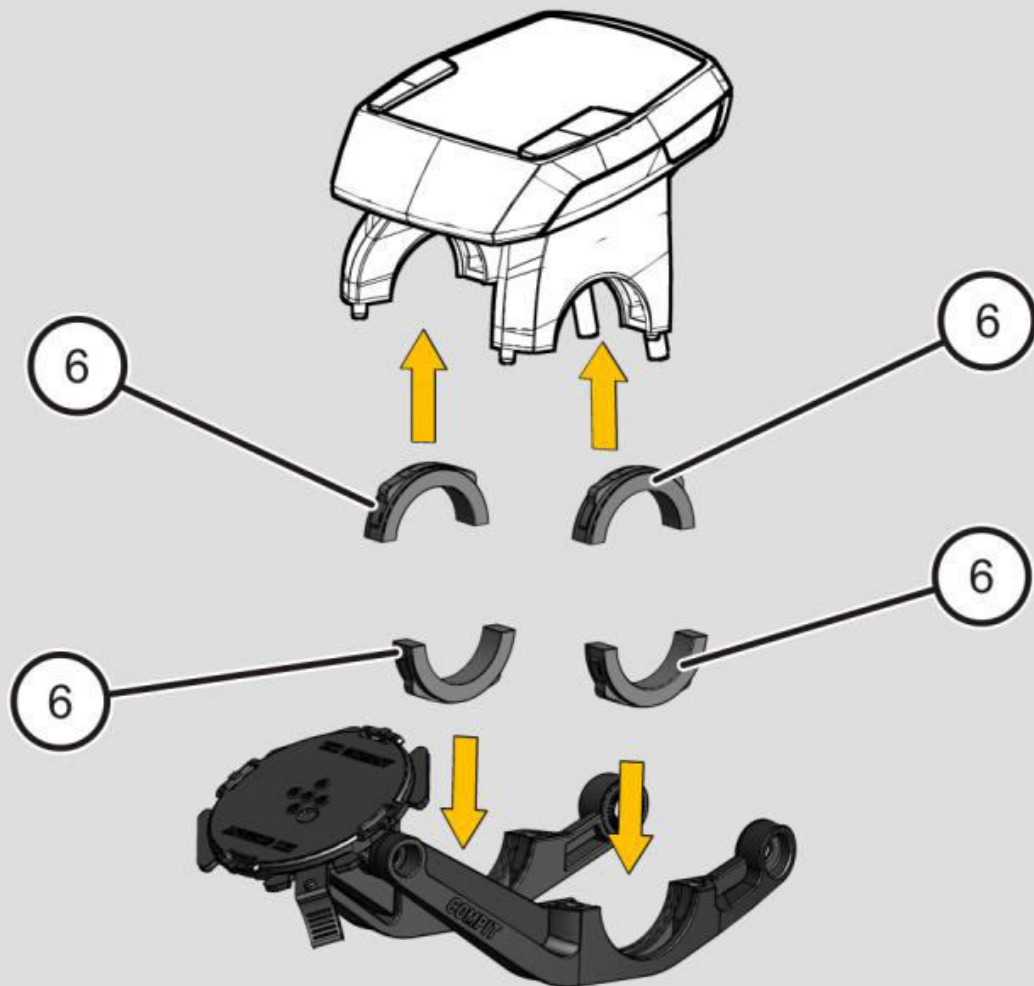

Mounting the COMPIT/E and COMPIT/E+ on and removing them from the bicycle's handlebar

- Now affix the on-board computer (7) and the COMPIT/E's clamping arms (8) on the bicycle's handlebar.

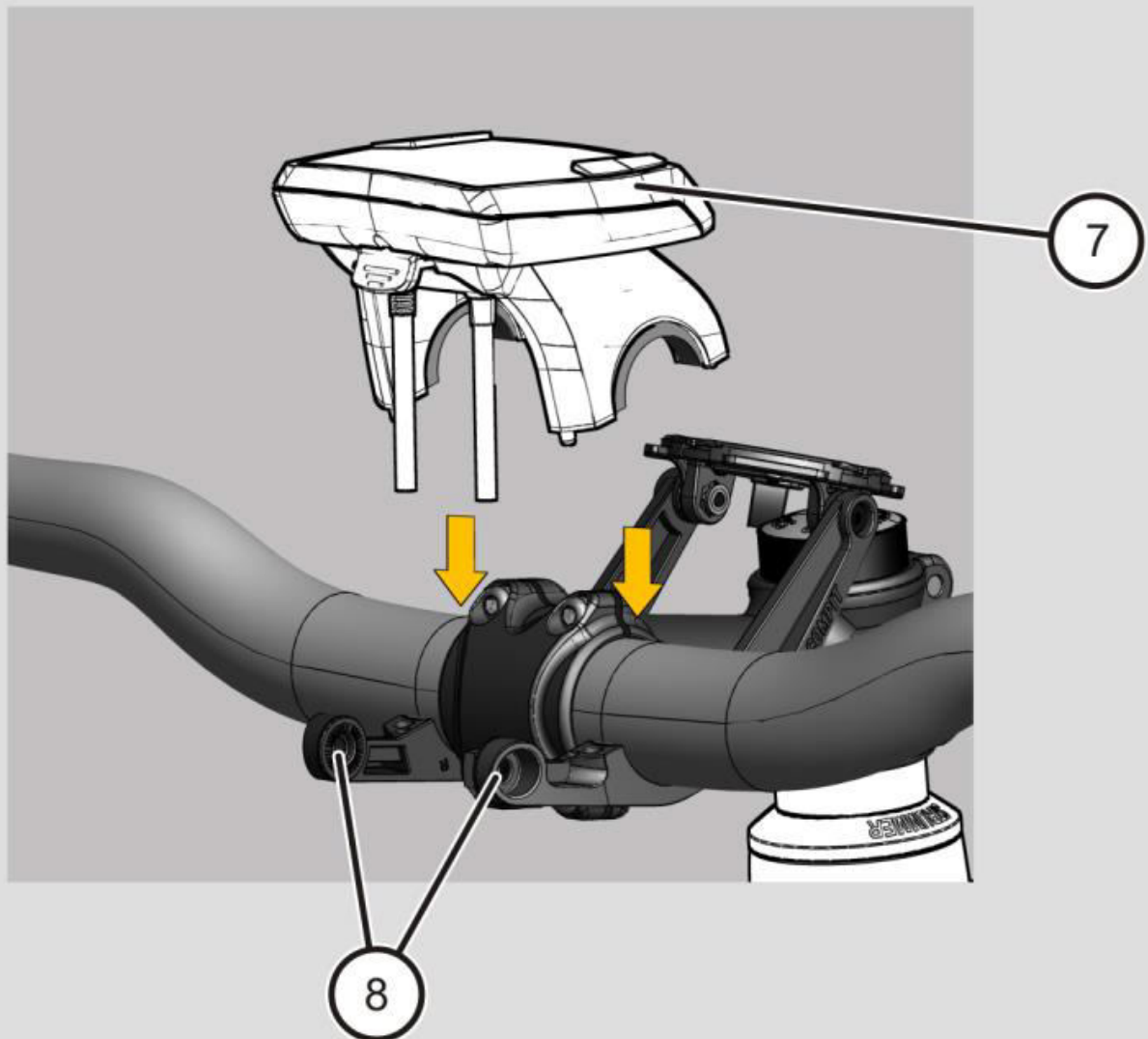

CAUTION



If the screws cannot be tightened evenly when mounting the COMPIT/E on the bicycle, the COMPIT/E may come loose from the bicycle and cause injury.

- When mounting the COMPIT/E, tighten the screws evenly, alternating between them.

- Mount the COMPIT/E on the handlebar with a torque wrench. To do so, tighten the screws (9) evenly (alternating between them) using the torque (1 Nm) indicated on the clamping arms.

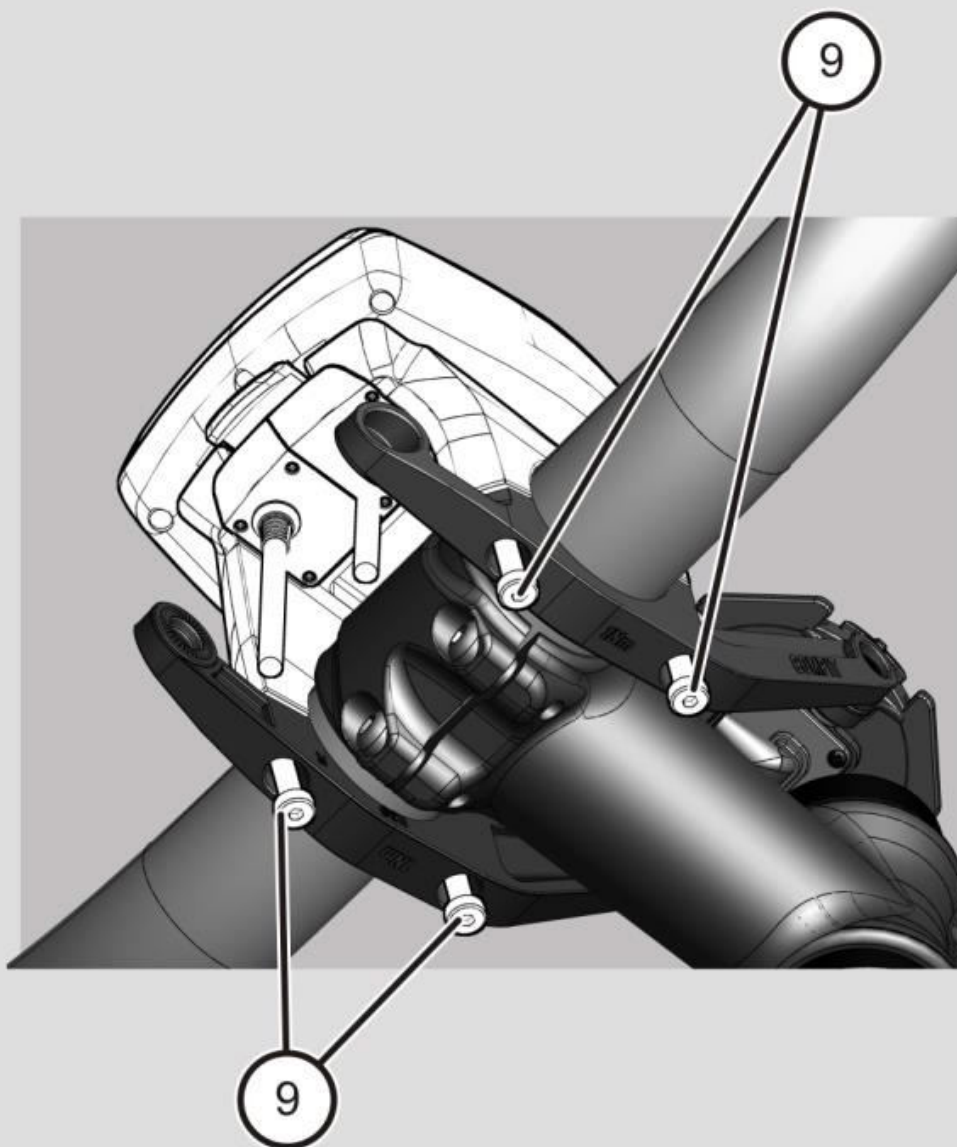

Mounting the COMPIT/E and COMPIT/E+ on and removing them from the bicycle's handlebar

- Now affix the COM/LIGHT (12) on the COMPIT/E (10).
- Tighten the screws (11) slightly.

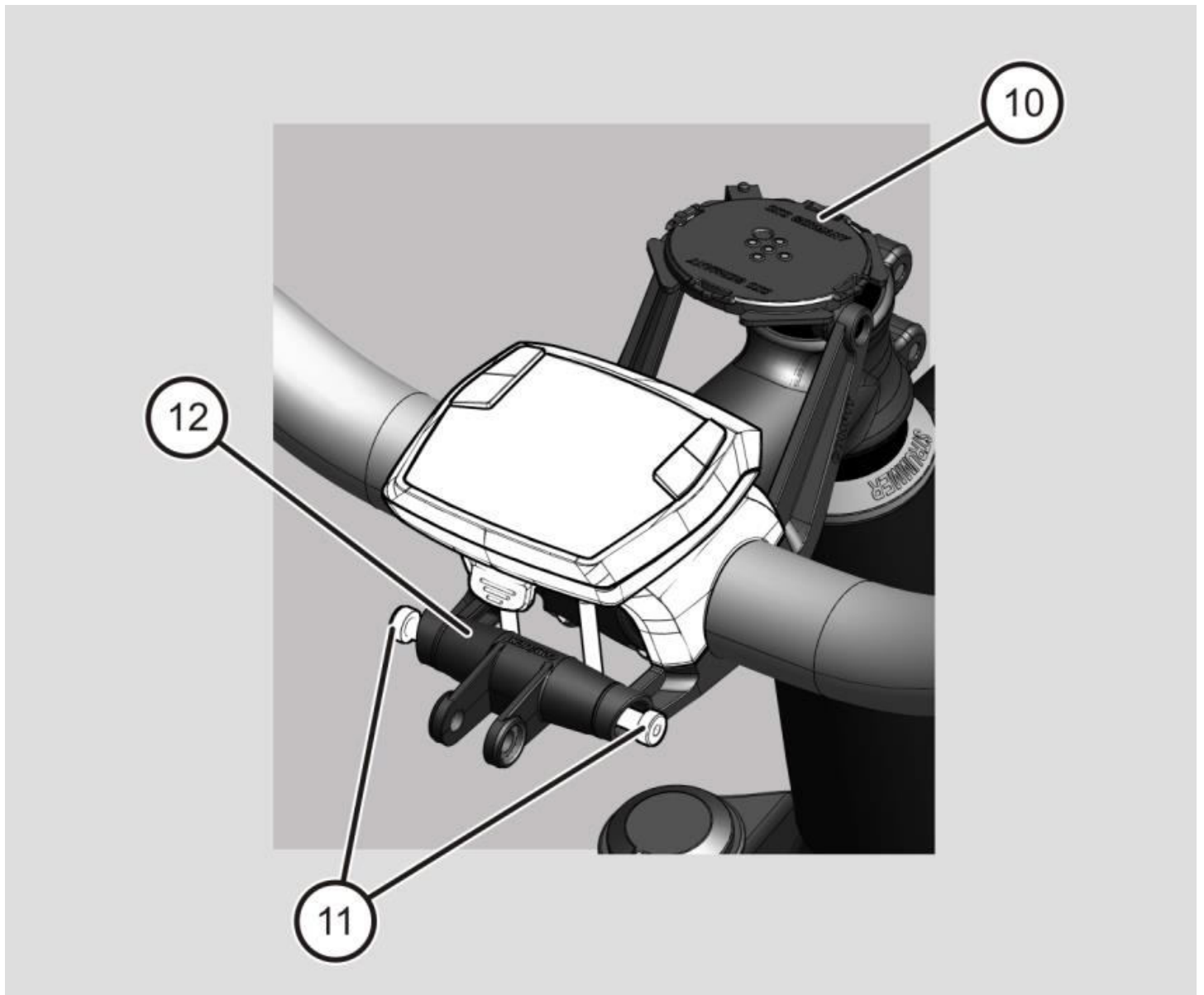

- ① The optional COM/CAM adapter can be mounted using the clamping arms in the same way as the COM/LIGHT.

Mounting the COMPIT/E and COMPIT/E+ on and removing them from the bicycle's handlebar

Once you have mounted the COMPIT/E on the bicycle's handlebar, you can affix a front light on the COM/LIGHT. Proceed as follows to do so:

- Insert the base of the front light (16) into the COM/LIGHT holder along with the locking washers (15) on each side of the lamp base and align all the holes.
- Insert the shaft (13) through the COM/LIGHT and the lamp base.
- Tighten the two screws (14) with the supplied Allen key.

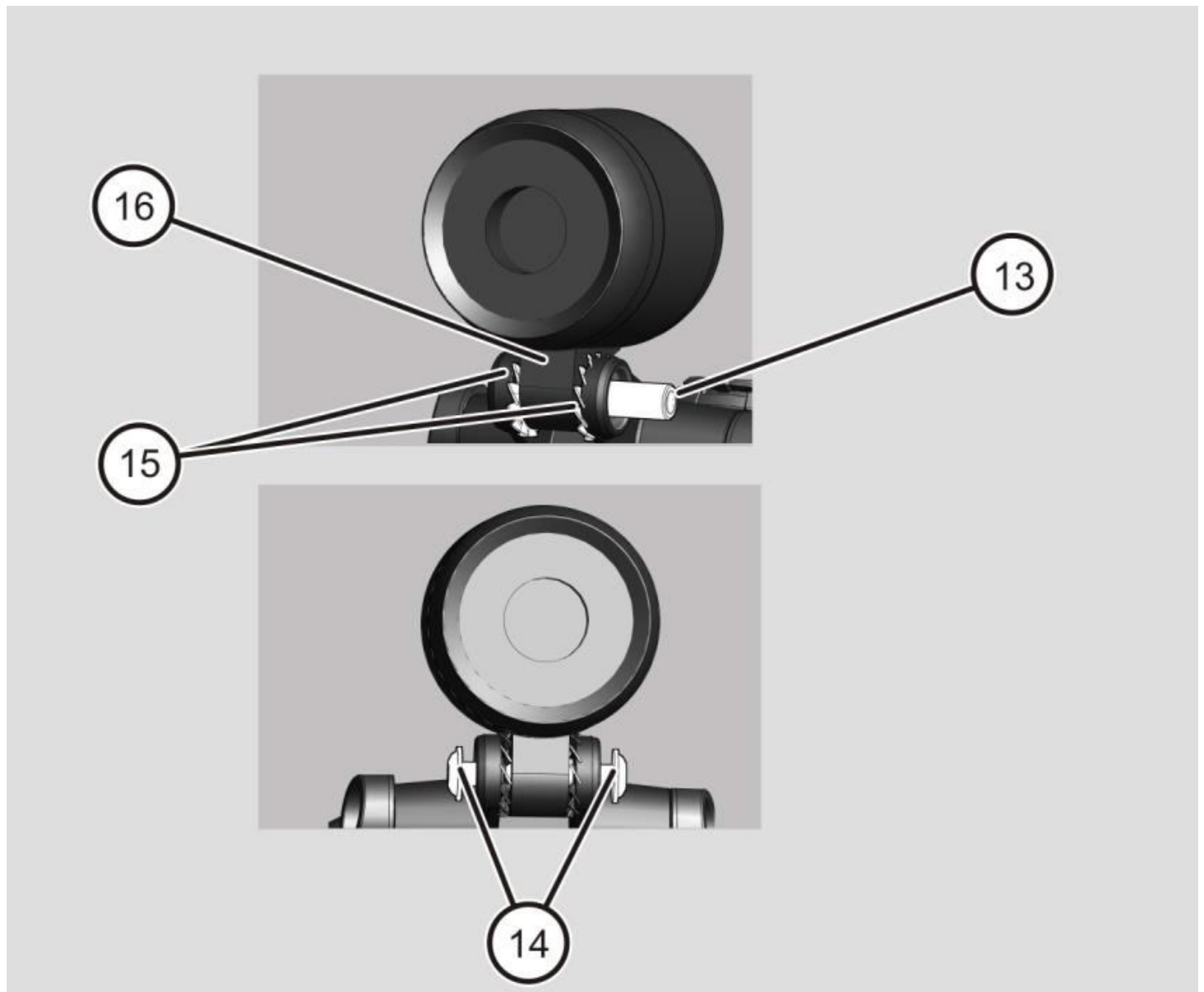

- ⓘ You must observe the maximum width of the lamp base (12 mm) and the minimum hole diameter (6 mm).

Proceed as follows to remove the COMPIT/E from the bicycle's handlebar:

- Loosen the screws on the COMPIT/E.
- Remove the COMPIT/E components from the bicycle handlebar.

Mounting your smartphone on the COMPIT/E or COMPIT/E+ and removing it

Proceed as follows to mount your smartphone on the COMPIT/E or COMPIT/E+:

- Insert your smartphone into the corresponding cover according to the relevant instructions.
- Place your smartphone on the COMPIT/E or COMPIT/E+ (as shown in 1 or 2) and turn it (about 45°) either to the right or left above the docking station until you hear it click into place.

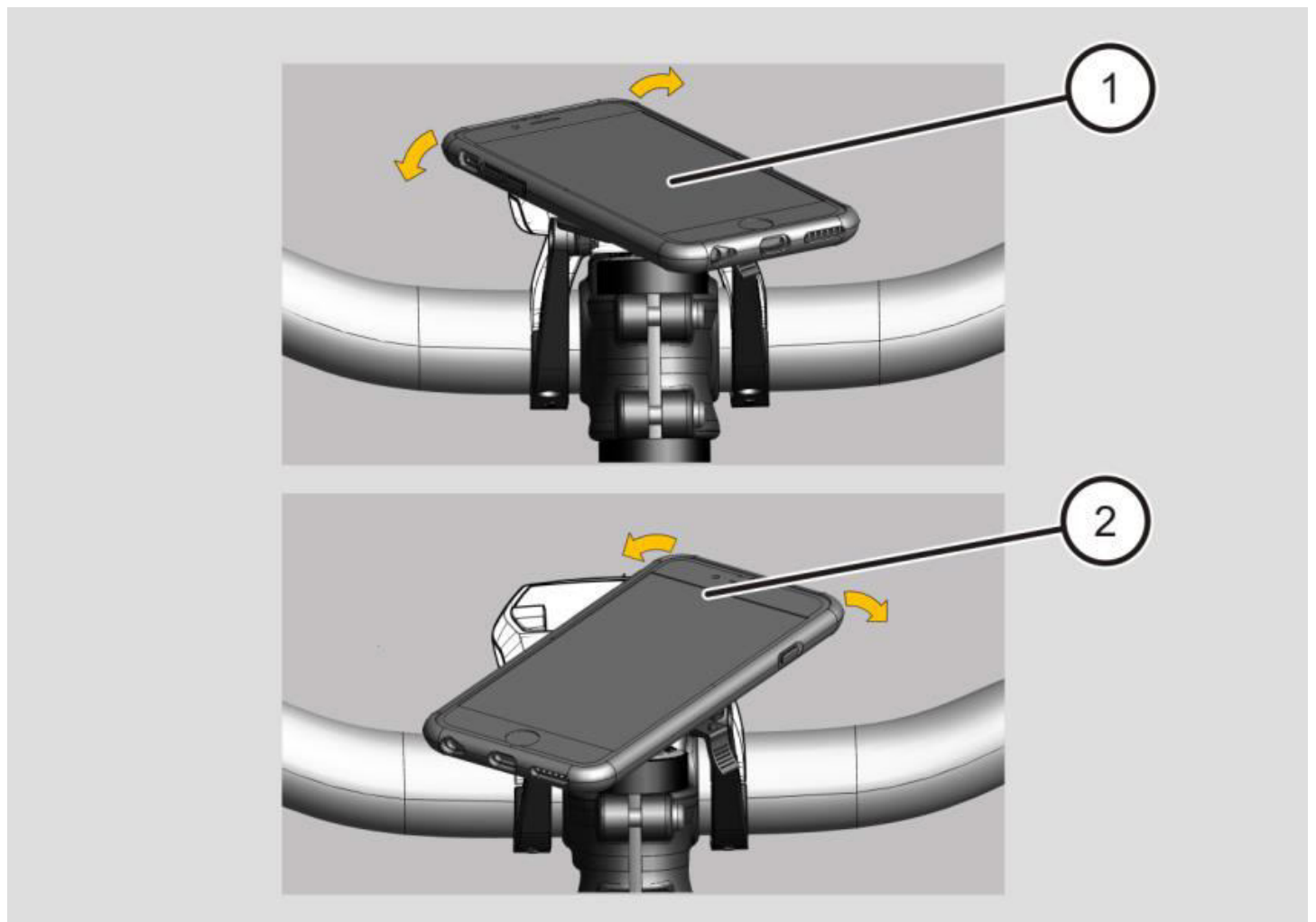

Mounting the COMPIT/E and COMPIT/E+ on and removing them from the bicycle's handlebar

Depending on how you turn it, your smartphone is mounted vertically (3) or horizontally (4).
The safety lever (5) is locked.

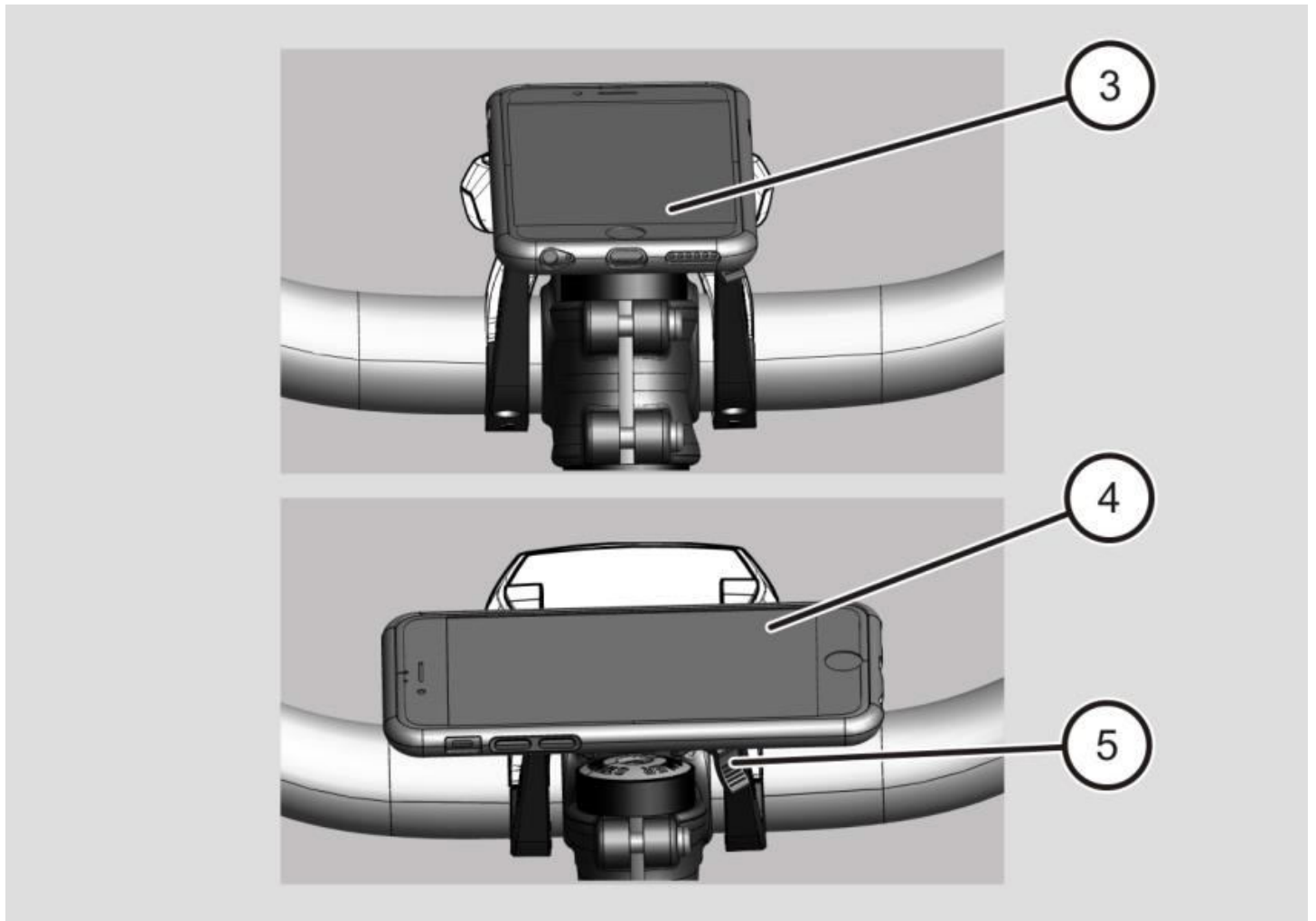

Proceed as follows to remove your smartphone from the COMPIT/E or COMPIT/E+:

- Push the safety lever (5) downwards.
- Remove your smartphone from the COMPIT/E or COMPIT/E+ by turning it (about 45°) off the docking station.

Adjusting the Inclination

You can move your smartphone into the desired position by adjusting the tilt on the COMPIT/E or COMPIT/E+. Proceed as follows to adjust the tilt:

- Press the smartphone (1) on the COMPIT/E or COMPIT/E+ downwards or upwards until you have reached the desired position.
- To fix the desired tilt setting, tighten the levelling screw (2).

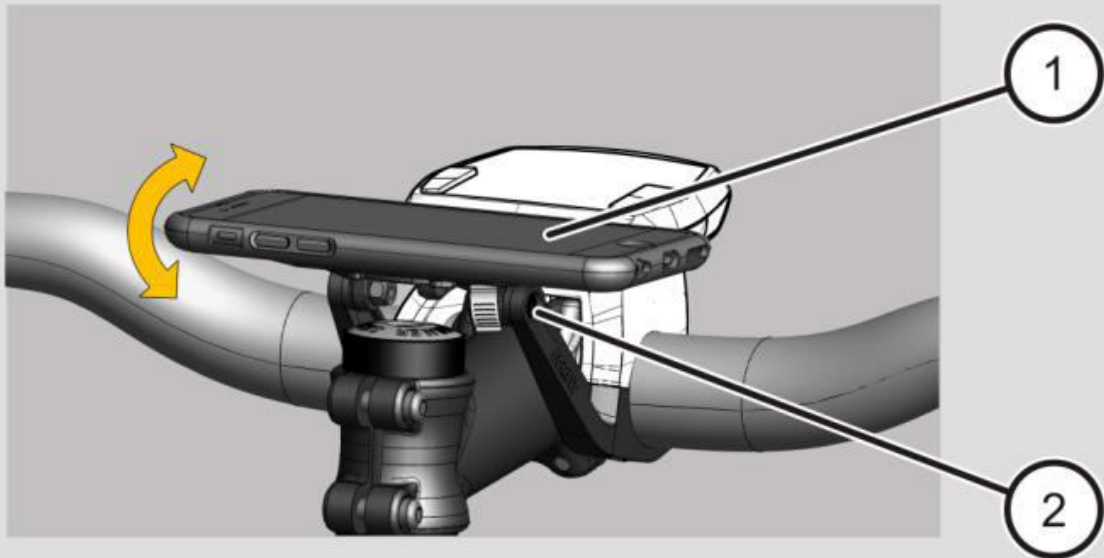

Charging the Smartphone via the +COM/UNIT

Cableless charging of the smartphone

If you have a smartphone with a Qi charging function, you can charge it without a cable while you're on the move using the +COM/UNIT. Proceed as follows in this regard:

- Ensure that the +COM/UNIT is sufficiently charged (min. 50%).
- Affix the +COM/UNIT on the COMPIT/E+ in the same way as the smartphone (please refer to page 33 regarding this matter).
- Press the  button on the +COM/UNIT to switch it on.

The bottom LED lights up blue and the battery indicator LEDs light up orange. The +COM/UNIT is now switched on.

- Place your smartphone on the +COM/UNIT's Qi docking station (as shown in 1 or 2) and turn it (about 45°) either to the right or left above the Qi docking station until you hear it click into place. The smartphone starts charging automatically.

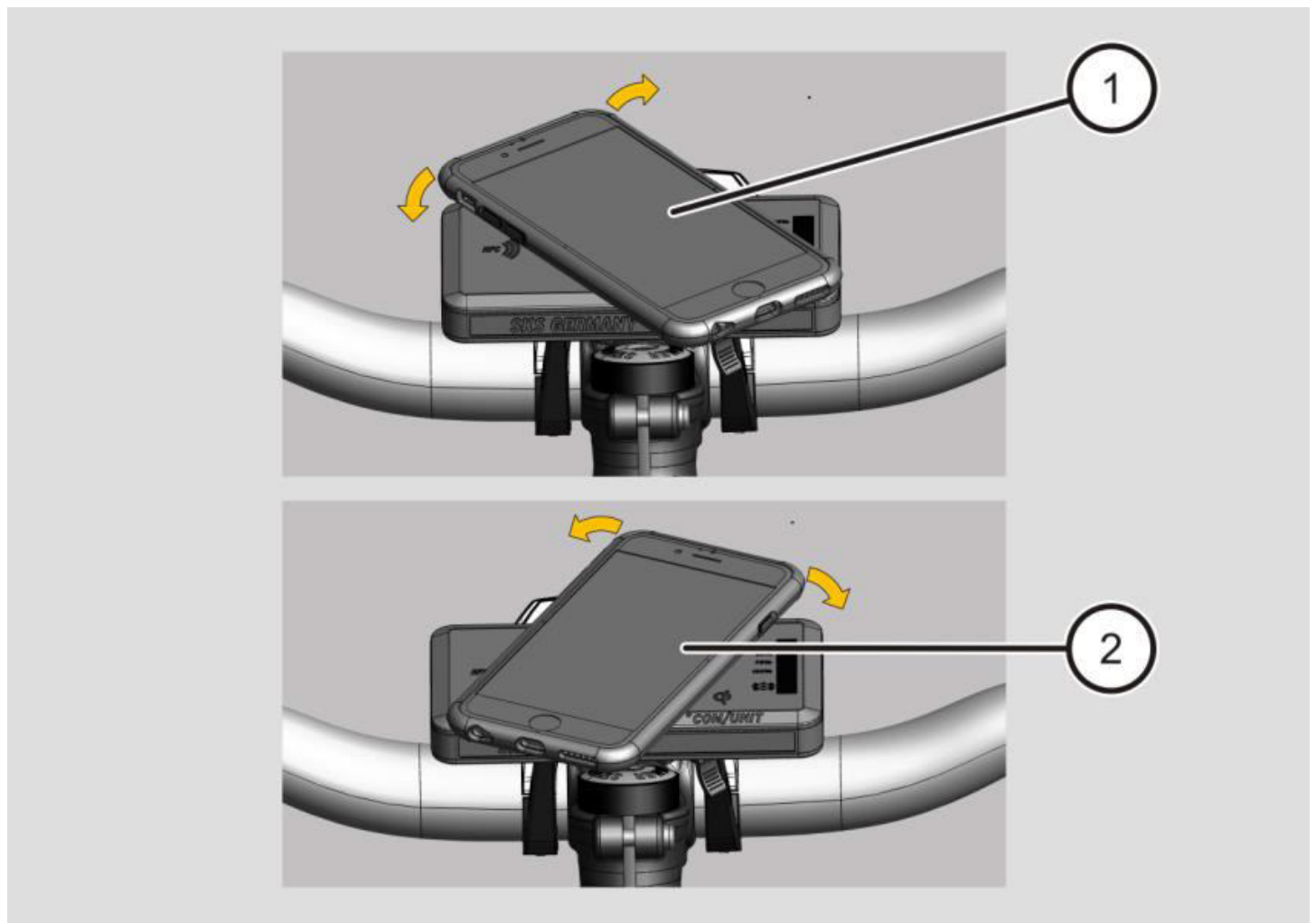

Charging the Smartphone via the +COM/UNIT

Depending on how you turn it, your smartphone is mounted vertically (3) or horizontally (4).

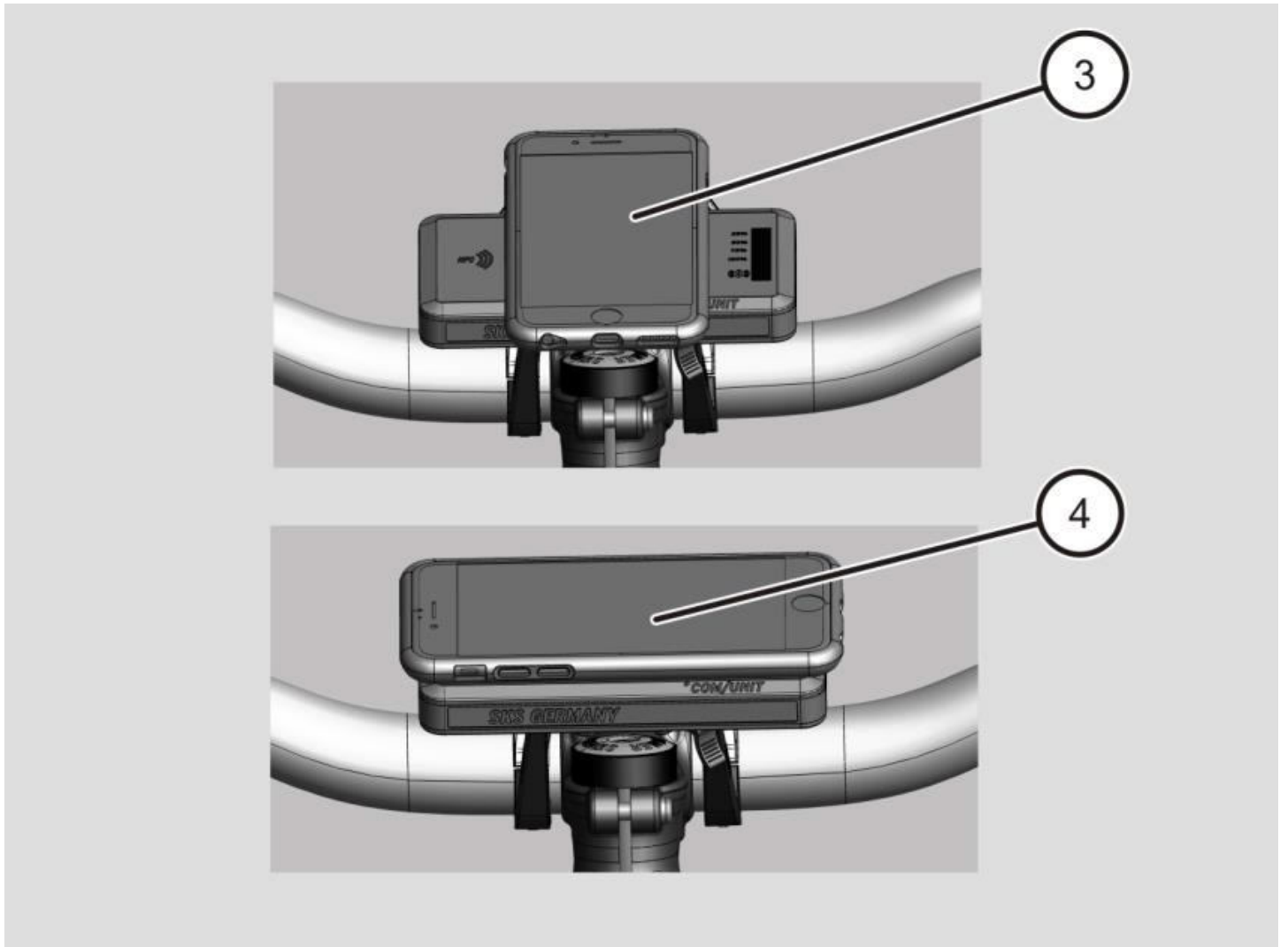

The bottom LED flashes blue. The smartphone is charging.

➤ To manually stop the charging process and switch off the +COM/UNIT without removing the smartphone from the +COM/UNIT, press the  button for approx. 2 seconds.

ⓘ If a smartphone is not connected for charging after 30 seconds at the latest, the +COM/UNIT switches off automatically.

Charging the smartphone with a cable

If you have a smartphone without a Qi charging function, you can charge it with an optional USB cable while you're on the move using the +COM/UNIT. Proceed as follows in this regard:

- Ensure that the +COM/UNIT is sufficiently charged (min. 50 %).
- Connect the optional USB cable (2) to the output socket of the +COM/UNIT (2).
- Now connect it to your smartphone (1).

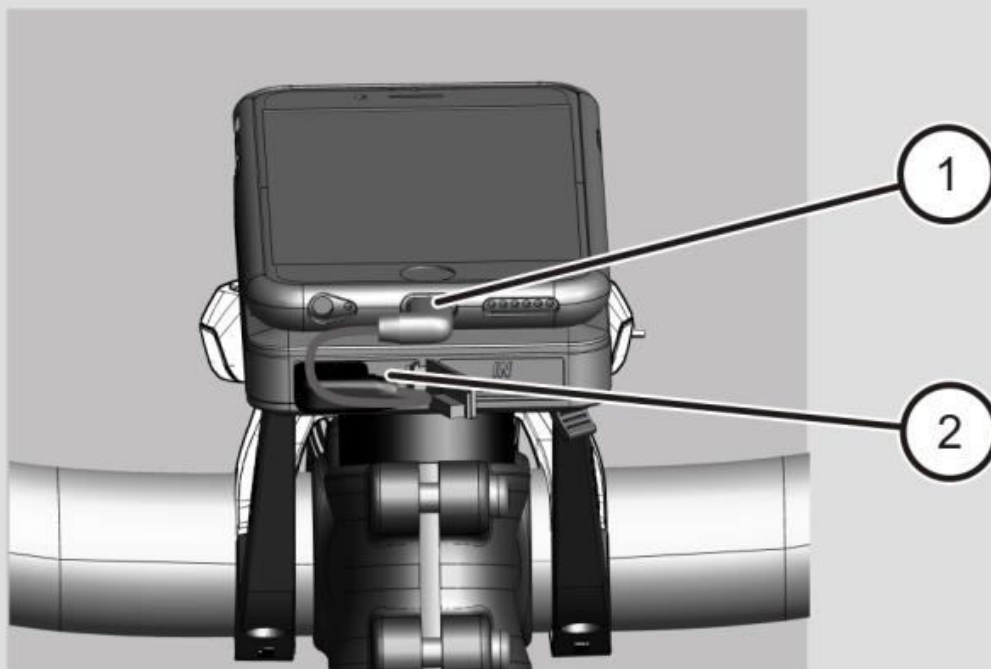

- Proceed as described in the section entitled Charging your smartphone without a cable to charge your smartphone. Please refer to page 36 regarding this matter.

Proceed as follows once your smartphone is charged:

- Remove the USB cable from your smartphone and from the +COM/UNIT.
- Remove your smartphone from the +COM/UNIT by turning it (approx. 45°) above the Qi docking station.
- Press the safety lever and remove the +COM/UNIT from the COMPIT/E or COMPIT/E+ in the same way as the smartphone.
- Recharge the +COM/UNIT if necessary. Please refer to page 42 regarding this matter.

Using the NFC

The +COM/UNIT is equipped with an NFC chip (NEAR FIELD COMMUNICATION). The NFC chip that is integrated in the +COM/UNIT can be put to various uses.

The most diverse contents can be stored on the NFC chip it then being possible to read these out using an NFC-capable smartphone. The content can be a URL, a text or commands and applications that are generated using an app for the writing of NFC chips.

This enables numerous smartphone settings to be changed at the same time when scanning the NFC chip of the +COM/UNIT in addition to it being possible to automatically start apps such as the SKS MYBIKE app.

You can use the NFC (NEAR FIELD COMMUNICATION) as follows:

- Activate the NFC (NEAR FIELD COMMUNICATION) on your smartphone.
- Hold your smartphone close to the NFC chip of the +COM/UNIT (1-4 cm).

The content of the NFC chips is read out and the function that is programmed on the NFC chip is executed.

Charging the +COM/UNIT and your smartphone using your e-bike's on-board computer

+COM/UNIT und Smartphone über Bordcomputer vom E-Bike laden

If you have an e-bike that uses a USB power supply (5 V/min. 0.5 A) on the on-board computer, you can charge the +COM/UNIT and your smartphone using the e-bike's on-board computer while cycling.

Proceed as follows to charge:

- Open the connection socket (1) of the e-bike's on-board computer.
- Insert the plug (2) of the COMPIT/E+'s cable into the connection socket (1) of the e-bike's on-board computer.

The +COM/UNIT charging process starts straight after the e-bike has been switched on. The orange LEDs flash one after the other. To charge the smartphone, proceed as described on page 40 onwards.

- ① If the smartphone is docked, it is charged first. The +COM/UNIT is charged once the smartphone is fully charged.

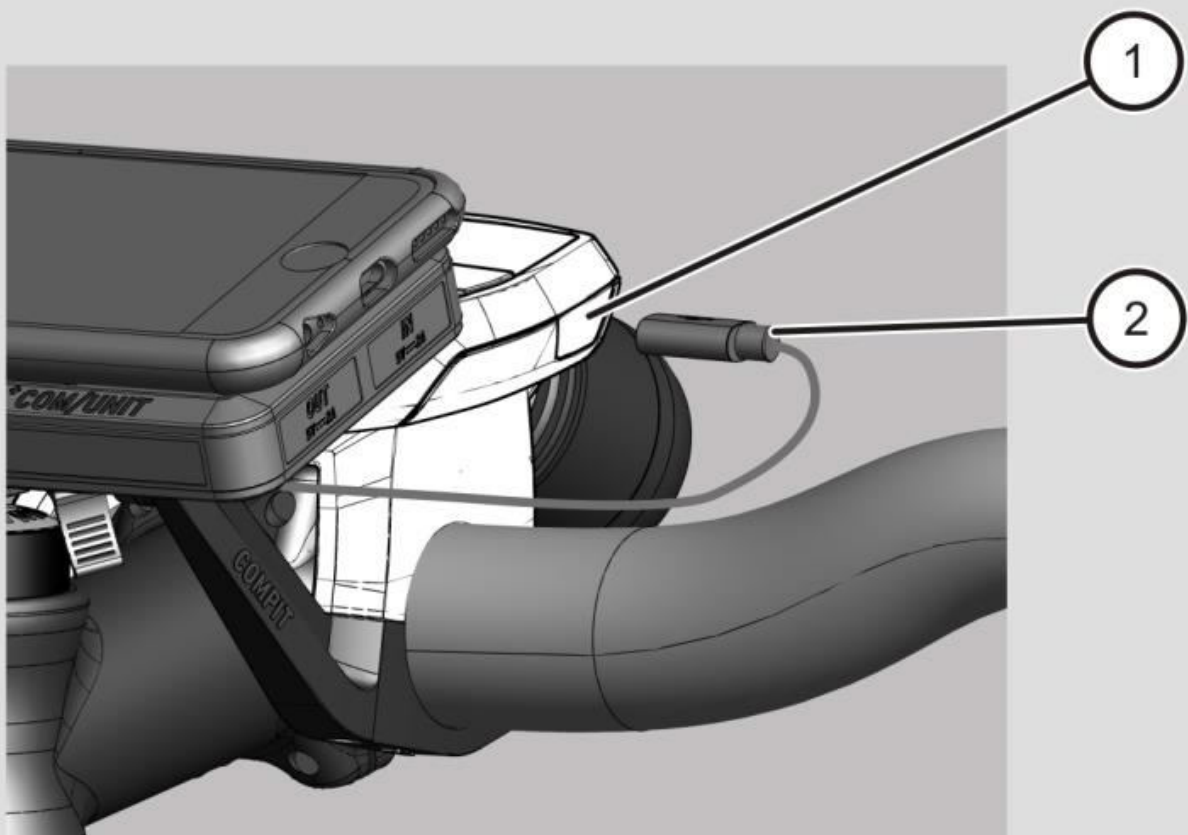

Charging the +COM/UNIT and your smartphone using your e-bike's on-board computer

- ① The smartphone cannot be continuously navigated with the e-bike if the +COM/UNIT is out of charge. The energy provided by the e-bike is too low to be able to navigate with the smartphone. The +COM/UNIT's battery indicator should show at least 50% charge to support the smartphone sufficiently during navigation.

Charging the +COM/UNIT

You can charge the +COM/UNIT as follows:

- Insert the plug of the USB cable that is included in the scope of delivery in the USB input port (1) and connect it with a suitable charger.



All four of the orange LEDs are illuminated if the +COM/UNIT battery is fully charged. The anticipated charging duration is approx. 6 hours (depending on the charger).

Troubleshooting

Sympton	Cause	Remedy
The blue LED on the +COM/UNIT is flashing fast.	Error when charging the smartphone	➤ Remove your smartphone from the +COM/UNIT and alter its position. When doing so ensure that your smartphone is positioned in the centre on the SKS logo.

Caring for the Product

Care for the product as follows:

- If necessary, clean the exterior of the product using a moistened cloth.

Accessories

Designation	Order number
Cover iPhone 6/7/8	11538
Cover iPhone 6+/7+/8+	11539
Cover iPhone X	11540
Cover SAMSUNG S7	11576
Cover SAMSUNG S8	11577
Cover SAMSUNG S9	11578
Cover HUAWEI P20 PRO+	11579

Designation	Order number
Cover adapter Dimensions: 60 x 60 x 4 mm	11541

Designation	Order number
Kabel iPhone Lightning	11542
Kabel Micro USB	11543
Kabel Typ C	11544

Designation	Order number
COM/CAM Adapter	11545

Designation	Order number
COM/LIGHT	11582

Disposing of the Product

In Germany

- Sort the product packaging and dispose of it accordingly. Make use of the local possibilities for the collection of paper, cardboard and lightweight packaging.
- The product and the accessories are not to be disposed of in the household waste. You can obtain information on collection points that accept old products free of charge from your local authority.



Outside Germany

- Dispose of the product and the packaging conform with the provisions that have validity for the place of use.

Warranty Declaration

SKS metaplast Scheffer-Klute GmbH GERMANY provides a 2-year warranty as from the date of purchase in the scope of the legal provisions for all parts that are included in the scope of delivery (proof with the purchase receipt). Wearing parts are excluded - this especially being the +COM/UNIT battery unit. This is covered by a 6 months SKS GERMANY warranty. An incorrect handling or wrong use excludes a liability for defects.

Returns to Customer Service

Please take the following action as soon as you detect damage on the product:

- Please return the product to the following address in the original packaging and enclose a precise description of the damage:

SKS metaplast Scheffer-Klute GmbH
Zur Huberstushalle 4
59846 Sundern
Tel.: +49-2933-8310

