

1. Prepare the COMPIT for the COM/PAD All COMPIT versions (except COMPIT/ANYWHERE)

1. Loosen and remove the levelling screws on both sides
2. Remove the docking station

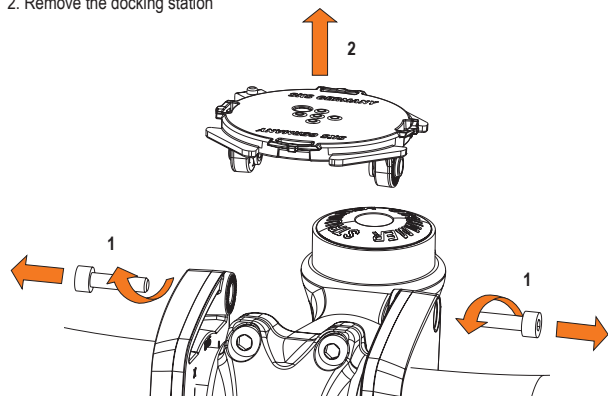

4. Insert the sealing ring again. Attach the connection plate with the cable and secure it with screws. Do not exceed the 0.15 Nm tightening torque of the screws.

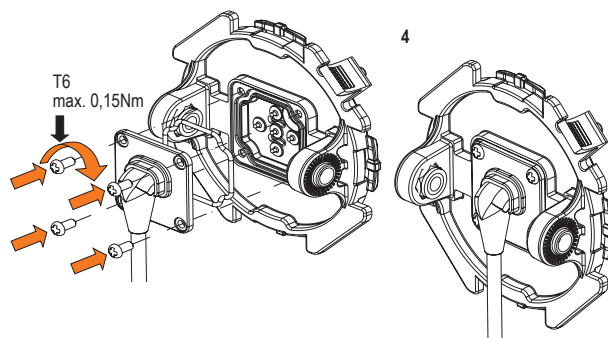

- 3-4. Loosen and remove the screws (T6). Remove and discard the dummy cover.

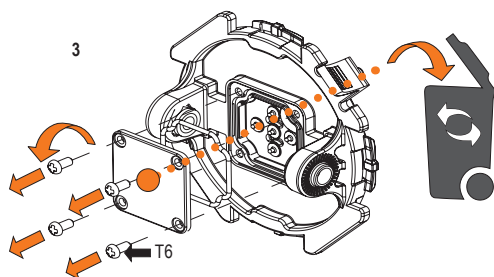

5. Insert the docking station between the retaining clamps.
6. Insert the levelling screws and tighten them slightly. Adjust the angle of the docking station. Tighten the levelling screws.

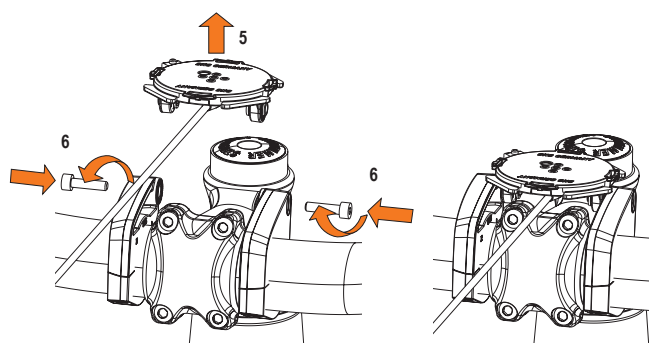

2. Connect the COMPIT to the e-bike

For e-bikes with a 12 V-36 V lighting system or power supply

Route the COMPIT connection cable to the motor, ensuring that the cable is routed cleanly along the cable routing specific to the bicycle model. Connect the COMPIT connection cable to the cable of the lighting system with waterproof terminals at a suitable point. Alternatively, solder connections can also be used. Motor (connection cable is not supplied)

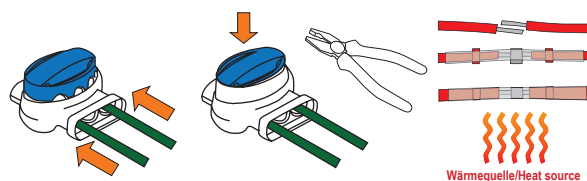
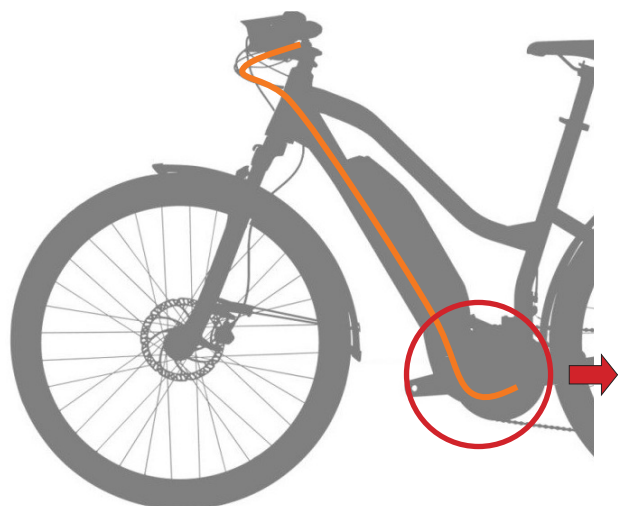

BOSCH Gen. 2,3 und 4
Active Line/Performance Line/CX
Front light connection

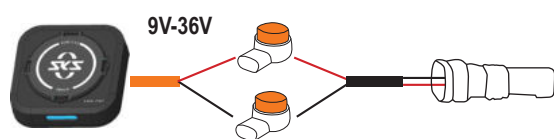

Yamaha PB-X
Front light connection 12 V

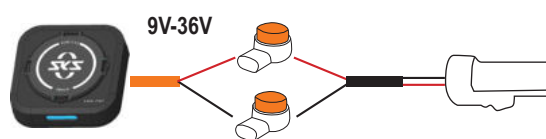

BOSCH Gen. 4
Light connection or 12 V aux.

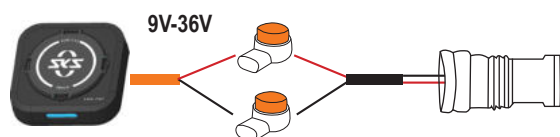

BAFANG M620
7015-BS-2 12V / 12W

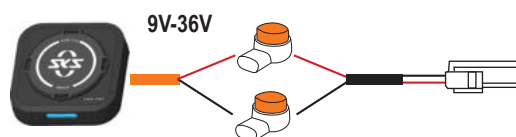

Fazua
JST VSLE 03R connector / 12 V

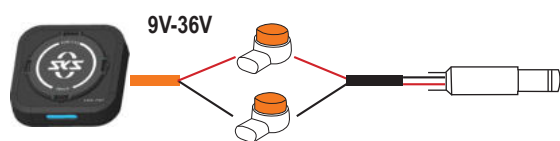

Shimano / screw terminals
Light connection 12 V

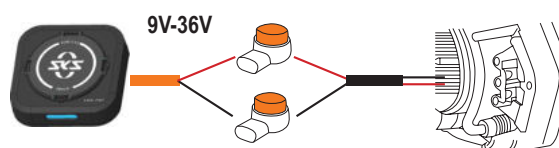

Brose S
Front light connection 12 V

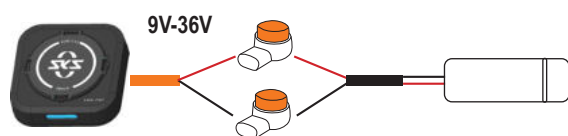

Panasonic
Light connection max. 36 V

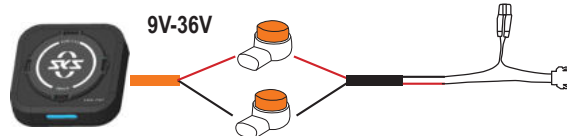

3. Attach the COM/PAD

Place the COM/PAD on the COMPIT and turn it (about 45°) either to the right or left above the docking station until you hear it click into place.

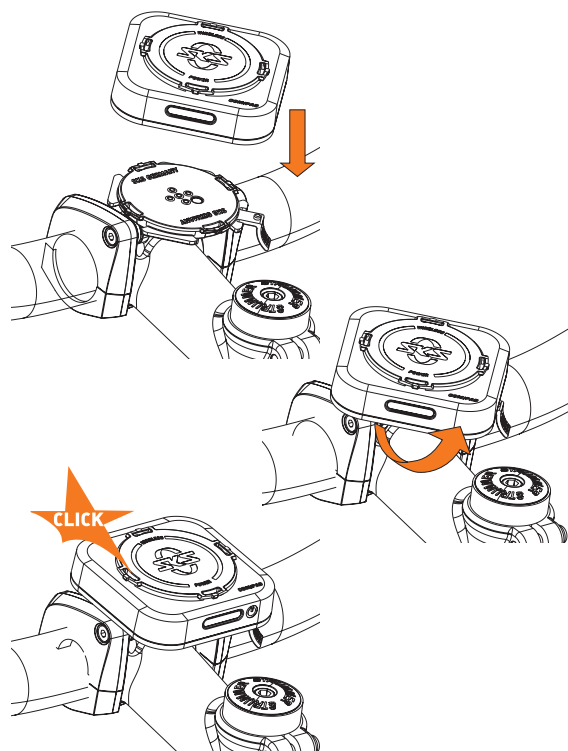

OPTIONAL!

Screw in the anti-theft lock screw as far as it will go.

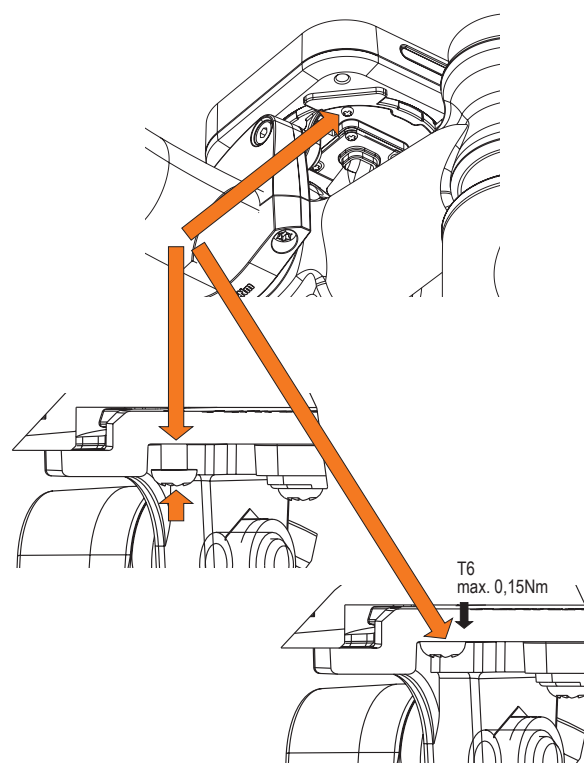

4. Activate the COM/PAD

Switch on the e-bike

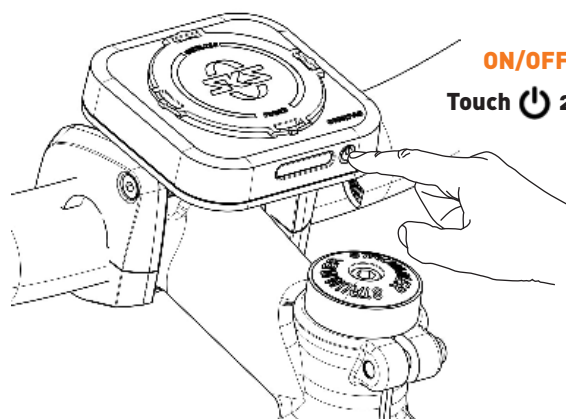
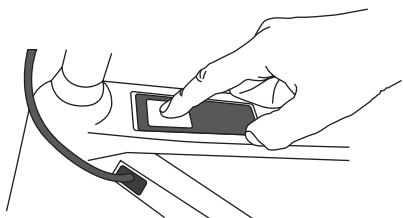

ON/OFF
Touch 2 sec.

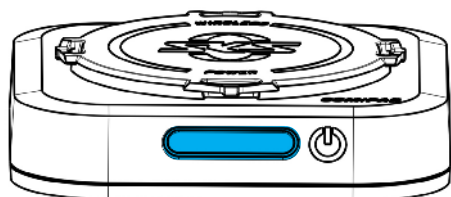

(((⚡))) ON

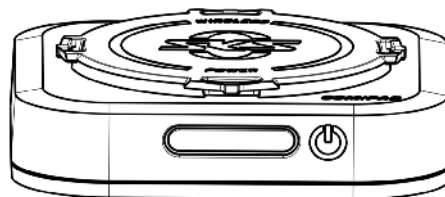

(((⚡))) OFF



USB C-PD OFF



USB C-PD ON

5. Charge the mobile device wirelessly

- 1 Switch on the COM/PAD. LED indicator lights up blue
- 2 Attach the mobile device and lock it by turning it
- 3 Mobile device is charged and LED indicator flashes blue.

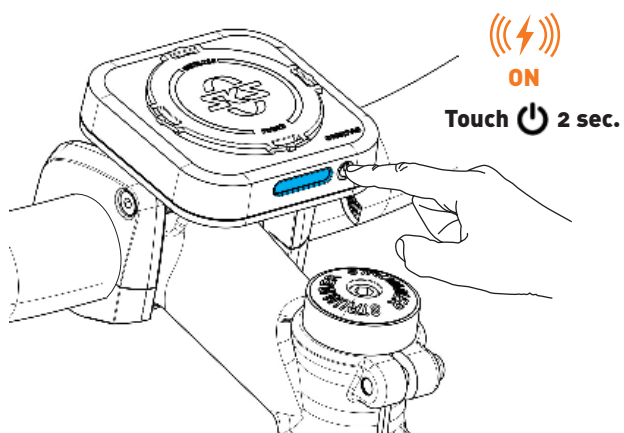

**(((⚡)))
ON**

Touch 2 sec.

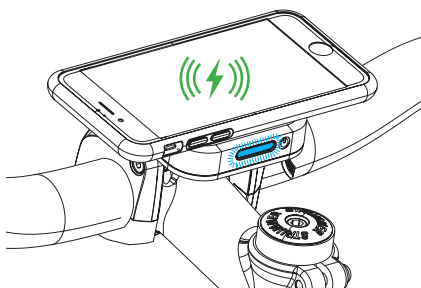
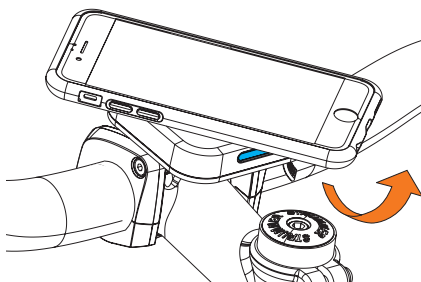
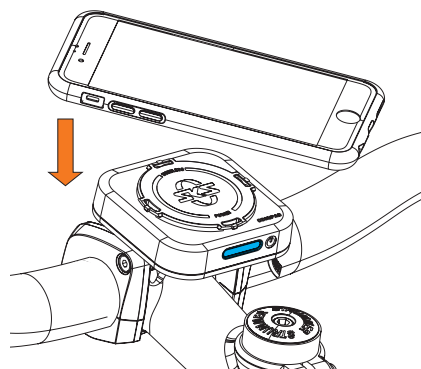

5 Charge the mobile device with cable

- 1 Switch on the COM/PAD USB C PD output. LED indicator is off!
 - 2 Connect the cable (not supplied) to the COM/PAD.
 - 3 Attach the mobile device and lock it by turning it
 - 4 Connect the cable (not supplied) to the mobile device.
- The mobile device is charging.

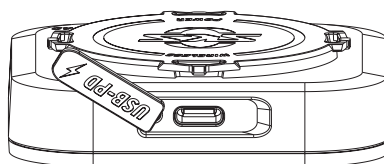
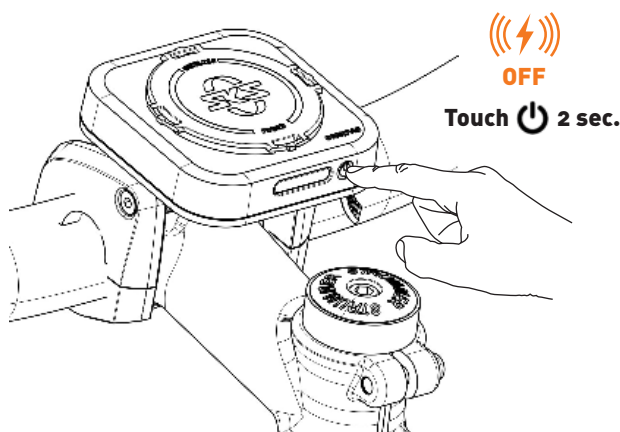

USB C-PD ON

